



भारत सरकार
Government of India
परमाणु ऊर्जा विभाग
Department of Atomic Energy
वैश्विक नाभिकीय ऊर्जा साझेदारी केन्द्र
Global Centre for Nuclear Energy Partnership



Ref No.: GCNEP/2024/01-67

Date: 16/01/2024

To,

The Advisor,
Ministry of Environment, Forest and Climate Change (Northern Region)
Bays No: 24-25, Sector-31 A,
Dakshin Marg, Chandigarh-160030

Sub: Half Yearly Compliance Report (Session: April 2023 to September 2023) of stipulated Environmental Conditions/ Safeguards in the Environmental Clearance Letter and Environmental Monitoring Report Expansion of Institutional Campus and Residential Township for Global Centre for Nuclear Energy Partnership (GCNEP) at Village- Kheri Jasaur and Jasaur Kheri, District- Jhajjar, Haryana by GCNEP

Ref: 1. Environmental Clearance No. SEIAA/HR/2018/231 dated 04.04.2018.
2. F.NO: 16-89/2018 (ENV)/333 dated 14.05.2019

Dear Sir,

This has reference to the EC vide letter no. **SEIAA/HR/2018/231 dated 04.04.2018**. In this regard, we are submitting hereby compliance report of stipulated conditions mentioned in the EC for your kind perusal for **submission period of December, 2023**.

In view of the above, information/documents are enclosed as follow

1. Point-wise compliance of the stipulated environmental condition/safeguards.
2. Environmental Quality Monitoring & Analysis Reports.
3. Supporting Documents

Thanking You,

Dr. Deep Prakash

Global Center for Nuclear Energy Partnership

(Authorized Signatory) डॉ. दीप प्रकाश / Dr. Deep Prakash
परियोजना निदेशक / Project Director
वैश्विक नाभिकीय ऊर्जा साझेदारी केन्द्र (जी सी एन ई पी)
Global Centre for Nuclear Energy Partnership / GCNEP
प.क.वि., भारत सरकार / D.A.E., Government of India
बहादुरगढ़ (हरियाणा) / Bahadurgarh (Haryana) - 124307

Name - Deep Prakash
Designation - Project Director
E-mail - pd@gcneep.gov.in
Contact No. - 011-23014587

31/1/24
Haryana State Pollution Control Board
C-11, Sector-11, Panchkula

Copy to:

1. The Member Secretary Haryana State Pollution Control Board, Panchkula, Haryana.
2. The Member Secretary SEIAA, Bays no. 55-58, Parytan Bhawan, 1st Floor, Sector-2, Panchkula, Haryana



भारत सरकार
Government of India
परमाणु ऊर्जा विभाग
Department of Atomic Energy
वैश्विक नाभिकीय ऊर्जा साझेदारी केन्द्र
Global Centre for Nuclear Energy Partnership



Ref No.: GCNEP/2024/01-67

Date: 16/01/2024

To,

The Advisor,
Ministry of Environment, Forest and Climate Change (Northern Region)
Bays No: 24-25, Sector-31 A,
Dakshin Marg, Chandigarh-160030

Sub: Half Yearly Compliance Report (Session: April 2023 to September 2023) of stipulated Environmental Conditions/ Safeguards in the Environmental Clearance Letter and Environmental Monitoring Report Expansion of Institutional Campus and Residential Township for Global Centre for Nuclear Energy Partnership (GCNEP) at Village- Kheri Jasaur and Jasaur Kheri, District- Jhajjar, Haryana by GCNEP

Ref: 1. Environmental Clearance No. SEIAA/HR/2018/231 dated 04.04.2018.
2. F.NO: 16-89/2018 (ENV)/333 dated 14.05.2019

Dear Sir,

This has reference to the EC vide letter no. **SEIAA/HR/2018/231 dated 04.04.2018**. In this regard, we are submitting hereby compliance report of stipulated conditions mentioned in the EC for your kind perusal for **submission period of December, 2023**.

In view of the above, information/documents are enclosed as follow

1. Point-wise compliance of the stipulated environmental condition/safeguards.
2. Environmental Quality Monitoring & Analysis Reports.
3. Supporting Documents

Thanking You,

Prakash

Global Center for Nuclear Energy Partnership

(Authorized Signatory) **डॉ. दीप प्रकाश / Dr. Deep Prakash**
परियोजना निदेशक / Project Director
वैश्विक नाभिकीय ऊर्जा साझेदारी केन्द्र (जी सी एन ई पी)
Global Centre for Nuclear Energy Partnership (GCNEP)
प.क.वि., भारत सरकार / D.A.E., Government of India
बहादुरगढ़ (हरियाणा) / Bahadurgarh, Haryana-150011

Name - Deep Prakash
Designation - Project Director
E-mail - pd@gcnep.gov.in
Contact No. - 011-23014587

Copy to:

1. The Member Secretary Haryana State Pollution Control Board, Panchkula, Haryana.
2. The Member Secretary SEIAA, Bays no. 55-58, Parytan Bhawan, 1st Floor, Sector-2, Panchkula, Haryana



Reg; Submission of Half -Yearly compliance for Environmental clearance for EXPANSION OF INSTITUTIONAL CAMPUS AND RESIDENTIAL TOWNSHIP FOR GLOBAL CENTER FOR NUCLEAR ENERGY PARTNERSHIP(GCNEP) AT VILLAGE-KHERI JASOUR AND JASOUR KHERI, DISTI.JHAJJAR, HARYANA for the period of December 2023.

Vardan Compliance <compliance@vardan.co.in>
To: Environment Wing IRO Chandigarh <ecompliance-nro@gov.in>

Mon, Feb 12, 2024 at 10:31 AM

Respected Sir,

Please find enclosed Half -Yearly compliance for Environmental clearance for EXPANSION OF INSTITUTIONAL CAMPUS AND RESIDENTIAL TOWNSHIP FOR GLOBAL CENTER FOR NUCLEAR ENERGY PARTNERSHIP(GCNEP) AT VILLAGE-KHERI JASOUR AND JASOUR KHERI, DISTI.JHAJJAR, HARYANA for the period of December 2023.

Reference: 1. EC Granted vide letter no- SEIAA/HR/2018/231 dated 04.04.2018.
2. **F.NO:** 16-89/2018 (ENV)/333 dated 14.05.2019

Thanks & Regards



Environmental Compliance
Department

☎ 0124-4343750 Extn 786/789
✉ compliance@vardan.co.in
📍 Plot No. 82A, Sec-5, IMT Manesar, Gurugram - 122051 (Hr), India



Ref No.:GCNEP/2024/01-67

Date: 16/01/2024

To,

The Advisor,
Ministry of Environment, Forest and Climate Change (Northern Region)
Bays No: 24-25, Sector-31 A,
Dakshin Marg, Chandigarh-160030

Sub: Half Yearly Compliance Report (Session: April 2023 to September 2023) of stipulated Environmental Conditions/ Safeguards in the Environmental Clearance Letter and Environmental Monitoring Report Expansion of Institutional Campus and Residential Township for Global Centre for Nuclear Energy Partnership (GCNEP) at Village- Kheri Jasaur and Jasaur Kheri, District- Jhajjar, Haryana by GCNEP

Ref: 1. Environmental Clearance No. SEIAA/HR/2018/231 dated 04.04.2018.
2. F.NO: 16-89/2018 (ENV)/333 dated 14.05.2019

Dear Sir,

This has reference to the EC vide letter no. SEIAA/HR/2018/231 dated 04.04.2018. In this regard, we are submitting hereby compliance report of stipulated conditions mentioned in the EC for your kind perusal for **submission period of December, 2023.**

In view of the above, information/documents are enclosed as follow

1. Point-wise compliance of the stipulated environmental condition/safeguards.
2. Environmental Quality Monitoring & Analysis Reports.
3. Supporting Documents

Thanking You,



Global Center for Nuclear Energy Partnership

डॉ. दीप प्रकाश / Dr. Deep Prakash
परियोजना निदेशक / Project Director
वैश्विक नाभिकीय ऊर्जा साझेदारी केन्द्र (जी.सी.एन.ई.पी.)
(Authorized Signatory) Global Centre for Nuclear Energy Partnership (G.C.N.E.P.)
प.ऊ.वि., भारत सरकार / D.A.E., Government of India
बहादुरगढ़ (हरियाणा) / Bahadurgarh (Haryana) -124507

Name - Deep Prakash
Designation - Project Director
E-mail - pd@gcnep.gov.in
Contact No. - 011-23014587

Copy to:

1. The Member Secretary Haryana State Pollution Control Board, Panchkula, Haryana.
2. The Member Secretary SEIAA, Bays no. 55-58, Parytan Bhawan, 1st Floor, Sector-2, Panchkula, Haryana

HALF YEARLY COMPLIANCE OF STIPULATED ENVIRONMENTAL CONDITIONS

AS PER THE ENVIRONMENTAL CLEARANCE
LETTER NO. SEIAA/HR/2018/231

DATED 4TH April 2018

FOR

EXPANSION OF INSTITUTIONAL CAMPUS AND RESIDENTIAL TOWNSHIP FOR

GLOBAL CENTER FOR NUCLEAR ENERGY
PARTNERSHIP (GCNEP) AT
VILLAGE-KHERI JASOUR AND JASOUR KHERI,
DISTT.JHAJJAR, HARYANA

Prakash

डॉ. दीप प्रकाश / Dr. Deep Prakash
परियोजना निदेशक / Project Director

PART A- SPECIFIC CONDITION: CONSTRUCTION PHASE

Condition 1: "Consent to Establish" shall be obtained from Haryana State Pollution Control Board under Air and water act and a copy shall be submitted to the SEIAA Haryana before the start of any construction work at the site.

Reply: Consent to Establish has been obtained from Haryana State Pollution Control Board for "Consent to Establish" under Air and Water Act vide letter no. HSPCB/Consent/:329962318JHACTE55066 Dated 03.10.2018, copy of CTE is enclosed as **Annexure-I**. CTE extension has been obtained for the period from 03.10.18 to 03.04.2025.

Condition-2: A first aid room as proposed in the project report shall be provided both during construction and operation phase of the project.

Reply: Agreed. First Aid Room is provided at site by the Contractor. First Aid Facilities are available at DCS&EM Site Office. In case of Snake bite, the treatment can be availed from village hospital for which the facility is available at hospital. Emergency vehicles are available at site during working hours. We are doing routine medical check-up for the labors those who are working at the construction site. Photograph showing First Aid room is attached as **Annexure -II**

Condition 3: Adequate drinking water and sanitary facilities should be provided for construction workers at the site. Provision should be made for mobile toilets. Open defecation by the labourers is strictly prohibited. The safe disposal of waste water and solid wastes generated during the construction phase should be ensured.

Reply: Agreed. Adequate Drinking water facility is being provided at Labour Hutments. Sanitary arrangements are also provided at labour Hutment Area & Site Offices. The open defecation by the labour is strictly prohibited. The wastewater generated during construction phase is being sent to the septic tanks. Photographs showing drinking water facility, toilet and septic tank are attached as **Annexure-III**.

Left over cement and mortar, cement concrete blocks, aggregates, sand and other inorganic material are being recycled. Solid waste management plan is enclosed as **Annexure-IV**.

Condition 4: All topsoil excavated during construction activities should be stored for use in horticulture/ landscape development within the project site.

Reply: Agreed. Excavated topsoil is being preserved separately which will be used for landscaping. Small landscaping made in front of the office is made of topsoil of Guest House Building. Photographs showing the topsoil storage is enclosed as **Annexure-V**.

Condition 5: The project proponent should ensure that the building material used in the construction phase should be stored within the project area and disposal of construction waste should not create

डॉ. दीप प्रकाश / Dr. Deep Prakash
परियोजना निदेशक / Project Director
वैश्विक नामिकाय क्षेत्रातील विकास (जी.सी.ए.पी.)
Worldwide Nomenclature Area Development (G.C.N.E.P.)

any adverse effect on the neighboring and should be disposed of after taking necessary precautions for general safety and health aspects of the people, only in the approved sites with the approval of competent authority.

Reply: Agreed. No significant muck excavation is being done at the project site, construction materials are being properly stored within project site. Cement Godown for Cement Storage is available. Store room at Township site is made. Store room at campus site is provided, and RMC plant with partition is also made. Photograph showing covered construction material enclosed as **Annexure-VI**.

Condition-6: Construction spoils, including bituminous materials and other hazardous materials must not be allowed to contamination of watercourses and the dump site for such materials must be secured so that they should not leak into groundwater and any hazardous waste generated during construction phase should be disposed of as per applicable rules and norms with necessary approval of Haryana State Pollution Control Board.

Reply: Agreed. Construction spoils such as bituminous material and other hazardous material are not allowed to contaminate water course, dumpsite is being provided inside the boundary of the project site. Hazardous waste generated during construction phase, is being disposed of as per applicable rules and norms.

Condition 7: The diesel generator sets to be used during construction phase should be of ultra low Sulphur diesel type and should conform to Environment (Protection) Rules prescribed for air and noise emission standard.

Reply: Agreed. There is a provision of 4 No. of DG Sets of total 3000 KVA capacity (4x750 KVA) for institution campus and 2 no. of DG sets of total capacity 640 KVA (2x320 KVA) for residential township for power backup. DG sets will be equipped with acoustic enclosures to minimize noise generation and adequate stack height for proper dispersion. BS IV or better-quality fuel will be used. During construction phase DG sets are enclosed in acoustic enclosed installed on the Finn base to minimize vibration and noise. Results of environmental monitoring carried out attached as **Annexure VII**.

Condition 8: The diesel required for operating DG sets shall be stored in underground tanks if required clearance from Chief Controller of Explosive shall be taken.

Reply: Agreed.

Condition 9: Ambient noise levels should confirm to the residential standards both during day and night. Incremental pollution loads on the ambient air and noise quality should be closely monitored during construction phase. Adequate measures should be taken to reduce ambient air and noise level during construction phase, so as to confirm stipulated residential standards of CPCB/MoEF.

Reply: Agreed. Ambient noise level is monitored during day and night and is conforming to the standards. Adequate measures have been adopted to reduce ambient air quality pollution and noise level during construction phase.



डॉ. दीप प्रकाश / Dr. Deep Prakash
परियोजना निदेशक / Project Director

ग्लोबल न्यूक्लियर एनर्जी पार्टनरशिप सेंटर (जी सी एन ई पी)

Global Centre for Nuclear Energy Partnership (G.C.N.E.P.)

Condition 10: Fly ash shall be used as building materials in the construction as per the provision of Fly Ash Notification of September 1999 and amendment as on 27th August 2003.

Reply: Fly ash based bricks are being used for construction of walls. All superstructure masonry works are being built using fly ash bricks. Photographs attached as **Annexure VIII**.

Condition 11: Storm water control and its re-use as per CGWB and BIS standard for various applications should be ensured.

Reply: Agreed. Standards of BIS and CGWB will be followed and water will be reused.

Condition 12: Water demand during construction phase should be reduced by uses of pre-mixed concrete, curing agent and other best practices.

Reply: Agreed and complied. RMC is being used for construction works. Photographs of batching plant enclosed as Annexure IX.

Condition 13: Roof should meet prescribed requirements as per Energy Conservation Building Code by using appropriate thermal insulation material.

Reply: Agreed. Insulation (50 mm thick Phenotherm board) is used as roof. Energy conservation details attached as Annexure X.

Condition 14: Opaque wall should meet prescribed requirements as per energy conservation building code which is proposed to be mandatory for all air conditioned spaces while it is desirable for non air conditioned spaces by use of appropriate thermal insulation to fulfill the requirement.

Reply: Agreed. Double walls are being constructed on all outer walls (230 mm+115 mm). Thermal insulation material is also provided between these walls.

Condition 15: The approval of competent authority shall be obtained for structural safety of the building on account of earthquake, adequacy in firefighting equipment etc. as per National Building Code including protection measures for light etc. If any forest land is involved in the proposed site, clearance under Forest Conservation Act shall be obtained from competent Authority.

Reply: Agreed. This is a project of Central Government, Department of Atomic Energy project. The project is conceived and detailed by in House designers, adhering to safety and design standards. No forest land is involved in the project. Forest NOC is attached as **Annexure-XI**.

Condition 16: The project proponent as stated in the proposal shall construct 11 rainwater harvesting pits for recharging the ground water with in project premises. Rain water harvesting pits shall be designed to make provision for silting chamber and removal of floating matter before entering harvesting pit Maintenance budget and person responsible for maintenance must be provided. Care shall also be taken that contaminated water do not enter any RHW pit.

डॉ. दीप प्रकाश / Dr. Deep Prakash
परियोजना निदेशक / Project Director
वैश्विक नाभिकीय ऊर्जा साझेदारी केन्द्र (जी.सी.एन.ई.पी.)
Global Centre for Nuclear Energy Partnership (G.C.N.E.P.)
प.ऊ.वि. भारत सरकार / D.A.E., Government of India

Reply: We will construct 50 rainwater harvesting pits for reaching the ground water within the project premises. Rain water harvesting pits will be designed to make provisions for silting chamber and removal of floating matter before entering harvesting pits.

Condition 17: The project proponent shall provide for adequate fire safety measures and equipment as required by Haryana Fire Service Act, 2009 and instructions issued by the local Authority/Directorate of fire from time to time. Further the project proponent shall take necessary permission regarding fire safety scheme/NOC from competent Authority as required.

Reply: Agreed. Fire doors are constructed at staircases, guest house corridor, electrical panel rooms and AHU Rooms. Smoke detector and wet risers with booster pumps and all firefighting accessories are available. Fire NOC attached as **Annexure XII**.

Condition 18: The project proponent shall submit assurance from the HBVNL for supply of 6700 KVA (5000 KVA for Institute campus & 1700 KVA for Residential Township project) of power supply before the start of construction. In no case project will be operational solely on generators without any power supply from any external power utility.

Reply: Agreed. We have already obtained assurance from the UHBVNL for supply of 6700 KVA of power supply. Same is enclosed as **Annexure-XIII**.

Condition 19: Detail calculation of power load and ultimate power load of the project shall be submitted to HBVNL under intimation to SEIAA Haryana before the start of the construction. Provisions shall be made for electrical infrastructure in the project area.

Reply: Agreed. We have already obtained required permission from HBVNL for supply of 6700 KVA power load for the Institution campus and residential township project.

Condition 20: The project proponent shall not raise any construction in the natural land depression/ Nallah/ Water course and shall ensure that the natural flow from the Nallah/ Water course is not obstructed.

Reply: Agreed. Irrigation channel is preserved by fencing works. Hume pipes are laid where ever is necessary. Village panchayat has taken to divert the drainage water from campus site. Additional storm water drain is constructed along the by-pass road at campus site.

Condition 21: The Project Proponent shall keep the plinth level of the building blocks sufficiently above the level of the approach road to the Project as per prescribed by-laws. Levels of the other areas in the Projects shall also be kept suitably so as to avoid flooding.

Reply: Agreed. Plinth levels are kept well above surrounding levels (+101.45m). Level of approach road is kept above the maximum water level during rainy season.

Condition 22: Construction shall be carried out so that density of population does not exceed norms approved by Director General Town and country Department, Haryana.

डॉ. दीप प्रकाश / Dr. Deep Prakash
परियोजना निदेशक / Project Director
हरियाणा विद्यापीठ संशोधन केंद्र (सी सी डी डी पी)
हरियाणा विद्यापीठ संशोधन केंद्र (सी सी डी डी पी)

Reply: Density of population will not exceed norms approved by Director General Town and Country Department Haryana due to construction of project.

Condition 23: The project proponent shall submit an affidavit with the declaration that ground water will not be used for construction and only the treated water should be used for construction.

Reply: No Borewell is dug at site for construction purpose. We are a government organization. We have submitted an undertaking stating that we will not use Ground water for construction, enclosed as **Annexure XIV**.

Condition 24: The project proponent shall not cut any existing tree in the project area and project landscaping plan should be modified to include those trees in the green area

Reply: Agreed. There is no requirement of cutting the trees. Only small bushes have been cleared for construction activity.

Condition 25: The project shall ensure that ECBC norms for composite climate zone are met. In particular building envelope, HVAC service, water heating, pumping, lighting and electrical infrastructure must meet ECBC norm.

Reply: Agreed. ECBC norms will be met. Building envelope, HAVC service, water heating, pumping, lighting electrical infrastructure will all be in energy efficient way and meet Energy conservation Building Code norms. LED/ CFL Fixture are used. Air conditions are working on R-410 A.

Condition 26: The project proponent shall provide 3 meter high barricade around the project area, dust screen for every floor above the ground, proper sprinkling and covering of stored material to restrict dust and air pollution during construction.

Reply: Agreed. Masonry boundary wall is constructed all around the site and water sprinkling is being done to restrict dust and air pollution during construction. Photographs attached as **Annexure XV and XVI** respectively.

Condition 27: The project proponent shall construct a sedimentation basin in the lower level of the project site to trap pollutant and other wastes during rains.

Reply: Agreed. Sedimentation basin will be constructed.

Condition 28: The project proponent shall provide Rasta of proper width and proper strength for each project before the start of construction.

Reply: We will provide proper Rasta of proper width and proper strength for the project before the start of construction work at project site.

Condition 29: The project proponent shall ensure that the U-value of the glass is less than 3.177 and maximum solar heat gain co-efficient is 0.25 for vertical fenestration.

Reply: Agreed. Hermetically sealed 38mm thick (12mm SGG cool lite platinum toughened glass + 18mm air gap+mm inner glass) with low U value glass for all structural glazing work is being used.

Condition 30: The project proponent shall adequately control construction dust like silica dust, non-silica dust, and wood dust. Such dusts shall not spread outside the project premises. The project proponent shall provide respiratory protective equipment to all construction workers.

Reply: Agreed. Proper measures are being taken to control dust on the site like water sprinkling, covering construction material vehicles, etc. Photographs of dust suppression enclosed as **Annexure XVI**. Site barricading is being done to prevent dust from spreading outside premises, photos enclosed as **Annexure XV**.

Condition 31: The project proponent shall provide fire control room and fire officer for building above 30 meters as per National Building code.

Reply: The height of institutional and residential building is G+2, The height of the building will not be raised above 30m.

Condition 32: The project proponent shall obtain permission of Mines and Geology Department for excavation of soil before the start of construction.

Reply: There is no basement provided on the project. If required at any stage. We will obtain permission from concerned department.

Condition 33: The project proponent shall seek specific prior approval from concerned local Authority /HUDA regarding provision of storm drainage and sewerage system including their integration with external services of HUDA/Local authorities beside other required services before taking up any construction activity.

Reply: Agreed.

Condition 34: The site for solid waste management plant is earmarked on the layout plan and the detailed project for setting up the solid waste management plant shall be submitted to the Authority within one month.

Reply: The site for solid waste plant has been earmarked on the layout plan. The same will be provided before operational stage. Site plan attached as **Annexure XVII**.

Condition 35: The Project proponent shall discharge excess of treated waste water/storm water in the public drainage system and shall seek permission of HUDA before the start of construction.

Reply: we will discharge excess of treated waste/storm water in the public drainage system. Application will be submitted to HUDA for drainage connection.

Condition 36: The project proponent shall ensure that structural stability to withstand earthquake of magnitude 8.5 on Richter scale.

Reply: The project is conceived and detailed by in house designers adhering to in vogue safety and design standards. All measures are being taken to ensure that building is earthquake resistant. All provisions of IS 1893 and IS 13920 are being followed in the structural design.

SPECIFIC CONDITIONS: OPERATIONAL PHASE

Condition a: "Consent to Operate" shall be obtained from Haryana State Pollution Control Board under air and water act and a copy shall be submitted to the SEIAA, Haryana.

Reply: Agreed. We will obtain Consent to operate for Expansion of GCNEP (Institute and Township) from Haryana State Pollution Control Board for "Consent to Operate" under Air and Water Act after completion of the construction work at the project site.

Condition b: The Sewage Treatment Plant (STP) should be installed for the treatment to the prescribed standards including odour and treated effluent sll be recycled to achieve zero exit discharge. The installation of STP should be certified by an independent expert and a report in this regard should be submitted to SEIAA, Haryana before the project is commissioned for operation. Tertiary treatment of waste water is mandatory. The project proponent shall remove not only ortho- phosphorus but total phosphorus to the extent of less than 2mg/lit. Similarly total Nitrogen level shall be less than 2mg/lit in tertiary treated waste water. Discharge of treated sewage shall confirm to the norms and standards of HSPCB, Panchkula. The project proponent shall implement such STP technology which does not require filter backwash.

Reply: Agreed. STP will be designed by specialized engineers of the Department. Tertiary treatment of waste water will be done, and the treated water will be reused in the project for horticulture and flushing.

Condition c: Separation of black and grey water should be done by use of dual plumbing line. Treatment of 100% grey water by decentralized treatment should be done ensuring that the re-circulated water should have BOD maximum 10 mg/litre and the recycled water will be used for flushing, gardening and DG set cooling etc. to achieve zero exit discharge.

Reply: Agreed. Dual Plumbing line will be used. The treated water from STP will be reused in the project for flushing and landscaping purposes.

Condition d: For disinfections of treated waste water ultra-violet radiation or ionization process should be used

Reply: Agreed. For disinfection of the treated water, ultra violet radiation will be used.

Condition e: Diesel power generating sets proposed as source of backup power for lifts, common areas illumination and for domestic use should be of enclosed type and confirm to the rule made under Environment Protection Act, 1986. The location of DG sets should be in the basement as promised by the project proponent with appropriate stack height i.e. above the roof level as per the

डॉ. दीप प्रकाश / Dr. Deep Prakash
परियोजना निदेशक / Project Director
द्वैतक नाभिकीय ऊर्जा साझेदारी केंद्र (जी.सी.एन.ई.पी.)
Global Centre for Nuclear Energy Partnership (G.C.N.E.P.)
प्र.ऊ.वि. भारत सरकार / D.A.E., Government of India
पुणे (Haryana) - 124507

CPCB norms. The diesel used for DG shall be ultra low sulphur content (35ppmsulphur), instead of low sulphur diesel.

Reply: Agreed. DG sets to be used for power backup will be of enclosed type and will confirm to EP Act 1986. The DG sets will run of BS IV or better fuel.

Condition f: Ambient Noise level should be controlled to ensure that it does not exceed the prescribed standards both within and at the boundary of Proposed Institutional campus & Residential Township:

Reply: Agreed. Proper mitigation measures as suggested in the EMP to control high noise levels will be ensured.

Condition g: The project proponent as stated in the proposal shall maintain at least 30.57% for institutional campus and 31.57% for residential township as green cover area for tree plantation especially all around the periphery of the project and on the road sides preferably with local species so as to provide protection against suspended particulates matter and noise. The open spaces inside the plot should be preferably landscaped and covered with vegetation/grass. Herbs & shrubs. Only locally available plant species shall be used.

Reply: Agreed.

Condition h: The project proponent shall strive to minimize water in irrigation by minimizing the grass area, using native verity, xeriscaping and mulching, utilizing efficient irrigation system, scheduling irrigation only after checking vapor-transpiration data.

Reply: Agreed. Water minimization will be done during the operation phase.

Condition i: The ground water level and its quality should be monitored regularly in consultation with Central Ground Water Authority.

Reply: Agreed.

Condition j: A report on energy conservation measures conforming to energy conservations norms finalize by bureau of energy efficiency should be prepared incorporating details about building materials & technology, "R & U factors etc" and submit to IA division of environment and forest department, Haryana in three months time.

Reply: Agreed.

Condition k: Energy conservation measures like installation of LED for the lighting the area outside the building should be integral part of the projects design and should be in place before project commissioning. Use of solar panels must be adapted to the maximum energy conversion

Reply: Agreed.

डॉ. दीप प्रकाश / Dr. Deep Prakash
परियोजना निदेशक / Project Director
वैश्विक नाभिकीय ऊर्जा साझेदारी केन्द्र (जी.सी.एन.ई.पी.)
Global Centre for Nuclear Energy Partnership (G.C.N.E.P.)
मंत्रालय, भारत सरकार / D.A.E., Government of India
बहादुरगढ़ (हरियाणा) / Bahadurgarh (Haryana)

Condition l: The project proponent shall use zero ozone depleting potential material in the insulation, refrigeration, air-conditioning and adhesive. The project proponent shall also provide Halon free fire suppression system.

Reply: Agreed.

Condition m: The solid waste generated should be properly collected and segregated as per requirements of MSW rules, 2000. The bio-degradable waste should be treated by appropriate technology at the site earmarked within the project area and dry/inert solid waste should be disposed off to the approved sites for land filling after recovering recyclable materials.

Reply: Agreed. Solid waste management Plan is attached as Annexure-IV

Condition n: The provision of the solar water heating system shall be as per the norms specified by HAREDA and shall be made operational in each building block.

Reply: Agreed.

Condition o: The traffic plan and the parking plan proposed by the project proponent should be adhered to meticulously with further scope of additional parking for future requirement. There should be no traffic congestion near the entry and exit points from the roads adjoining the proposed project site. Parking should be fully internalized and no public space should be used.

Reply: Agreed. Traffic cum parking plan enclosed as Annexure-XVIII

Condition p: The project shall be operationalized only when HUDA/local authority will provide domestic water supply system in the area.

Reply: Agreed.

Condition q: Operation and maintenance of STP, solid waste management and electrical Infrastructure, pollution control measures shall be ensured even after the completion of sale.

Reply: Agreed.

Condition r: Different type of wastes should be disposed off as per provisions of municipal solid waste, biomedical waste, hazardous waste, e waste, batteries & plastic rules made under Environment Protection Act, 1986, Particularly waste and battery waste shall be disposed off as per existing E waste Management rules 2011 and batteries management rules 2001. The project proponent should maintain a collection center for E-waste and it should be disposed of to only registered and authorized dismantler/recycler.

Reply: Agreed. MSW will be disposed off as per MSW Rules. Other wastes will be disposed off to authorized vendors as per prescribed rules of MoEF and CPCB.

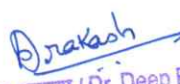
डॉ. दीप प्रकाश / Dr. Deep Prakash
परियोजना निदेशक / Project Director
वैश्विक नाभिकीय ऊर्जा साझेदारी केंद्र (जी.सी.एन.ई.पी.)
Global Centre for Nuclear Energy Partnership (G.C.N.E.P.)
भारत सरकार / D.A.E., Government of India
बहादुरगढ़ (हaryana) / Bahadurgarh (Haryana) - 124402

Condition s: Standards for discharge of environmental pollutants as enshrined in various schedules of rule 3 of Environmental Protection Rule 1986 shall be strictly complied with.

Reply: Agreed. As per Environment protection Rule 1986 standard for discharge of environment pollutant will be complied.

Condition t: The project proponent shall make provision for guard pond and other provision for safety against failure in the operation of waste water treatment facilities. The project proponent shall also identify acceptable outfall for treated effluent.

Reply: Agreed. During failure of STP, automatic valve will be drained out in sewerage system. Project will provide guard pond.

Condition u: The project proponent shall ensure that the stack height of DG sets is as per the CPCB guide lines that the emission standards of noise and air are within the CPCB latest prescribed limits. Noise Level of D.G sets greater than 800 KVA shall be as per CPCB latest standard for high capacity D.G sets.

Reply: Agreed.

Condition v: All electric supply exceeds 100 amp, 3 phase shall maintain the power factor between 0.98 lag to 1 at the point of connection.

Reply: Agreed.

Condition w: The project proponent shall minimize heat island effect through shading and reflective or pervious surface instead of hard surface.

Reply: Agreed. The Project proponent will minimize heat island effect through shading and reflective or pervious surface instead of hard surface.

Condition x: The Project Proponent shall not use fresh water for HVAC and DG cooling. Air based HVAC system should be adopted and only treated water shall be used by project proponent for cooling, if it is at all needed. The Project Proponent shall also use evaporative cooling technology and double stage cooling system for HVAC in order to reduce water consumption. Further temperature, relative humidity during summer and winter seasons should be kept at optimum level. Variable speed drive, best Co-efficient of Performance, (CoP), as well as optimal integrated point load value and maximum outside fresh air supply may be resorted for conservation of power and waste. Coil type cooling DG Sets shall be used for saving cooling water consumption for water cooled DG Sets.

Reply: Agreed.

Condition y: The project proponent shall ensure that the transformer is constructed with high quality grain oriented, low loss silicon steel and virgin electrolyte grade copper. The project proponent shall obtain manufacturer's certificate also for that.

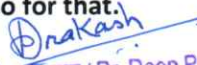
डॉ. दीप प्रकाश / Dr. Deep Prakash
परियोजना निदेशक / Project Director
वैश्विक नाभिकीय ऊर्जा साझेदारी केन्द्र (जी.सी.एन.ई.पी.)
Global Centre for Nuclear Energy Partnership (G.C.N.E.P.)
भारतीय परमाणु आयोग / D.A.E., Government of India
बान्दुगुम (हरियाणा) / Bandugum (Haryana)

Reply: Yes, Transformers from certified manufacturers will be used as per the requirements.

Condition z: Water Supply shall be metered among different users and different utilities.

Reply: We will meter different residential units and different utilities in operational phase.

Condition aa: The project proponent shall ensure that exit velocity from the stack should be sufficiently high. Stack shall be designed in such a way that there is no stack down-water under any meteorological condition.

Reply: Agreed. Stack will be designed in such a way that there will not be stack down wash under any meteorological conditions.

Condition ab: The project proponent shall provide water sprinkling system in the project area to the suppress the dust in addition to the already suggested mitigation measures in the Air Environment Chapter of EMP.

Reply: Agreed.

Condition ac: The project proponent shall provide additional green area on terrace and roof top.

Reply: Agreed.

Condition ad: The Project Proponent shall ensure proper Air Ventilation and light system in the basement area for comfortable living of human being and shall ensure that number of air changes per hour (ACH) in basement never falls below 15. In case of emergency capacity for increasing ACH to the extent of 30 must be provided by the project proponent.

Reply: Agreed.

Condition ae: The project proponent shall install solar panel for energy conservation.

Reply: Agreed.



डॉ. दीप प्रकाश / Dr. Deep Prakash
परियोजना निदेशक / Project Director
वैश्विक नाभिकीय ऊर्जा साझेदारी केन्द्र (जी.सी.एन.ई.पी.)
Global Centre for Nuclear Energy Partnership (G.C.N.E.P.)
प.ऊ.वि., भारत सरकार / D.A.E., Government of India
बहादुरगढ़ (हरियाणा) / Bahadurgarh (Haryana) - 124507

PART B- GENERAL CONDITIONS

Condition 1: The project proponent shall ensure the commitments made in Form-1, Form-1A, EIA/EMP and other documents submitted to the SEIAA for the protection of environment and proposed environmental safeguards are complied with in letter and spirit. In case of contradiction between two or more documents or any point, the most environment friendly commitment shall be taken as commitment by the project proponent.

Reply: The environment safeguards contained in the EIA/EMP Report are being implemented in letter and spirit.

Condition 2: The Project Proponent shall also submit Six monthly reports on the status of compliance of the stipulated EC conditions including results of monitored data (both in hard copies as well as by e-mail) to the northern Regional Office of MoEF, the respective Zonal Office of CPCB, HSPCB and SEIAA Haryana.

Reply: We are regularly submitting the semiannual environmental compliance report along with the monitoring details and lab reports in both soft and hard forms to the SEIAA and the regional office, MoEF. GOI, Northern region, Chandigarh.

Condition 3: STP outlet after stabilization and stack emission shall be monitored monthly. Other environmental parameters and green belt shall be monitored on quarterly basis. After every 3 months, the project proponent shall conduct environmental audit, and shall take corrective measures, if required, without any delay.

Reply: The environmental parameters will be monitored as per the guidelines.

Condition 4: The SEIAA, Haryana and reserve the right to add additional safeguards measures subsequently, If found necessary. Environmental clearance granted will be revoked if it is found that false information has been given for getting approval of this project. SEIAA reserves the right to revoke the clearance if conditions stipulated are not implemented to the satisfaction of SEIAA / MoEF.

Reply: Agreed.

Condition 5: The Project proponent shall not violate any judicial orders /pronouncements issued by court/Tribunal.

Reply: We will respect and not violate any judicial orders/ pronouncements issued by the Court / Tribunal.

Condition 6: All other statutory clearance such as approval for storage of diesel from Chief Controller of Explosives, Fire Department, Civil Aviation Department, Forest Conservation Act, 1980, and Wildlife (Protection) Act, 1972, Forest Act, 1927, PLPA 1900, etc. shall be obtained, as applicable by project proponent from the respective authorities prior to construction of the project.

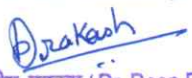
डॉ. दीप प्रकाश / Dr. Deep Prakash
परियोजना निदेशक / Project Director

Reply: All statutory clearance will be obtained. Copies of applicable NOC already obtained are attached in this report.

Condition 7: The project proponent shall inform the public that the project has been in accorded Environmental clearance by SEIAA and copies of the clearance letter are available with the State Pollution Control Board & SEIAA. This should be advertised within 7 days from date of issue of clearance letter at least in two local newspapers that are widely circulated in the region and copy of the same should be forwarded to SEIAA Haryana. A copy of environmental clearance conditions shall also be put on the project proponent's web site for public awareness.

Reply: Agreed. Advertisement copy is enclosed as **Annexure-XIX**

Condition 8: Under the provision of Environment (Protection) Act, 1986, legal action shall be initiated against the project proponents if it was found that construction of the projects has been started before obtaining prior Environmental Clearance.

Reply: Construction has been commenced only after obtained prior environmental clearance.

Condition 9: Any appeal against this Environmental Clearance shall lie with the National Green Tribunal, If preferred within a period of 30 days as prescribed under section 16 of the National Green Tribunal Act, 2010.

Reply: Agreed.

Condition 10: The project proponent shall put in place corporate environment policy as mentioned in MoEF, GOI OM No. J-11013/4112006-IA II (I) dated 26.4.2012 within 3 months period. Latest Corporate Environment policy should be submitted to SEIAA within 3 months of issuance of this letter.

Reply: Corporate environmental policy is not applicable to us since we are Government of India Department. However, we are carrying out activities like infrastructure development in and around Jasaur and Kheri desalination plant, computer training center around Jhajjar and Anganwadis in and around Jhajjar. We have earmarked Rs. 219 lakhs for such developmental activities. We have already contributed Rs. 50 Lakhs for promoting education by construction Govt. Girls degree college at Jasaur Kheri, Bahadurgarh, Haryana.

Condition 11: The fund ear-marked for environment protection measures should be kept in separate account and should not be diverted for other purposes and year wise expenditure report should be submitted to the SEIAA/RO MoEF, GOI under rules prescribed for Environmental Audit.

Reply: Agreed. Funds earmarked for environment protection are kept in a separate account and will not be diverted for any other purpose.

Condition 12: The project proponent shall ensure the compliance of Forest Department, Haryana Notification no. S.O.121/PA2/1900/S.4/97 dated 28.11.1997.

Reply: Agreed.

डॉ. दीप प्रकाश / Dr. Deep Prakash
परियोजना निदेशक / Project Director
भारतीय परमाणु ऊर्जा आयोग (बी.पी.एन.ई.पी.)
Global Centre for Nuclear Energy Partnership (GCNEP)
Ministry of Atomic Energy, Government of India

Condition 13: The project proponent shall ensure that no vehicles during construction/ operation phase enter the project premises without valid 'Pollution under Control' certificate from competent Authority.

Reply: Entry of any vehicle without "Pollution under Control" will be prohibited.

Condition 14: The project proponent shall seek fresh Environment Clearance if at any stage there is change in the planning of the proposed project.

Reply: Agreed. We will seek for a new clearance for any modification in the project.

Condition 15: Nodal Officer (Project Director) nominated by GCNEP shall be responsible for implementation of all conditions of Environmental clearance letter.

Reply: Agreed.

Condition 16: The Proponent shall upload the status of compliance of the stipulated EC conditions, including results of monitored data on their website and shall update the same periodically. It shall simultaneously be sent to the Regional Office of MoEF, the respective zonal office of CPCB and the SPCB. The criteria pollutant levels namely; $PM_{2.5}$, PM_{10} , SO_x , NO_x , Ozone, Lead, CO, Benzene, Ammonia, Benzo-pyrene, Arsenic and Nickel. (Ambient level as well as Stack emissions) or critical sectoral parameters, indicated for the project shall be monitored and displayed at a convenient location near the main gate of the company in the public domain.

Reply: Agreed.

Condition 17: The Environmental Statement for each financial year ending 31st March in Form-v as is mandated to be submitted by the project proponent to the HSPCB Panchkula as prescribed under the Environment (Protection) Rules, 1986, as amended subsequently, shall also be put on the website of the company along with the status of compliance of the EC conditions and shall also be sent to the respective Regional Offices of MoEF by e-mail.

Reply: Agreed.

Condition 18: The Project Proponent shall conduct environment audit at every three months interval and thereafter corrected measures shall be taken without any delay. Details of environmental audit and corrective measures shall be submitted in the monitoring report.

Reply: Agreed.

Condition 19: The validity of this environment clearance letter is valid upto to 7 Years from the day to issuance of EC letter. The environment clearance conditions applicable till life space project in case of Residential project will continue to apply. The residential welfare association/ housing co-operative societies shall responsible to comply conditions laid down in EC. In case of violation the action would be taken as per e laid down law of land. Compliance report should be sent to this office till the report. Reply: Agreed.

डॉ. दीप प्रकाश / Dr. Deep Prakash
परियोजना निदेशक / Project Director
वैश्विक नाभिकीय ऊर्जा साझेदारी केन्द्र (जी.सी.एन.ई.पी.)
Global Centre for Nuclear Energy Partnership (G.C.N.E.P.)
नवम्बर / D.A.E., Government of India

Condition 20: If project is not completed within the validity period then the project proponent shall submit the application for extension of validity within one month before the lapse of validity.

Reply: Agreed.

डॉ. दीप प्रकाश / Dr. Deep Prakash
परियोजना निदेशक / Project Director
वैश्विक नाभिकीय ऊर्जा साझेदारी केन्द्र (जी.सी.एन.ई.पी.)
Global Centre for Nuclear Energy Partnership (G.C.N.E.P.)
प.ऊ.वि., भारत सरकार / D.A.E., Government of India
बहादुरगढ़ (हरियाणा) / Bahadurgarh (Haryana) -124507



HARYANA STATE POLLUTION CONTROL BOARD

**SCF No. 42 & 43, Shopping Centre, Sector-6, Huda,
Bahadurgarh Ph. 01276-243077 (O)**

Website: www.hspcb.gov.in E-Mail - hspcb.pkl@sifymail.com

Telephone No.: 0172-2577870-73



No. HSPCB/Consent/ : 329962318JHACTE5554066

Dated:03/10/2018

To.

M/s : Global Centre for Nuclear Energy Partnership (Institute and Township)
Village Jasuar Kheri and Kheri Jasaur, Tel Bahadurgarh
JHAJJAR
124505

Sub. : Grant of consent to Establish to M/s Global Centre for Nuclear Energy Partnership (Institute and Township)

Please refer to your application no. 5554066 received on dated 2018-08-27 in regional office Bahadurgarh.

With reference to your above application for consent to establish, M/s Global Centre for Nuclear Energy Partnership (Institute and Township) is hereby granted consent as per following specification/Terms and conditions.

Consent Under	AIR/WATER
Period of consent	03/10/2018 - 03/04/2025
Industry Type	Building and construction project having waste water generation more than 100 KLD
Category	RED
Investment(In Lakh)	81100.0
Total Land Area (Sq. meter)	946600.3
Total Builtup Area (Sq. meter)	92979.0
Quantity of effluent	
1. Trade	202.0 KL/Day
2. Domestic	0.0 KL/Day
Number of outlets	1.0
Mode of discharge	
1. Domestic	
2. Trade	through STP
Permissible Domestic Effluent Parameters	
1. BOD	30 mg/l
2. COD	250 mg/l
3. TSS	100 mg/l
4. O&G	10 mg/l

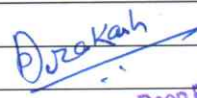
डॉ. दीप प्रकाश / Dr. Deep Prakash
 परियोजना निदेशक / Project Director
 वैश्विक नाभिकीय ऊर्जा साझेदारी केंद्र (जी.सी.एन.ई.पी.)
 Global Centre for Nuclear Energy Partnership
 भारत सरकार / D.A.E., Government of India
 Bahadurgarh (Haryana)

Permissible Trade Effluent Parameters	
1. NA	mg/l
Number of stacks	1
Height of stack	
1. DG sets 6 no.	6 meters
Permissible Emission parameters	
1. NA	
Capacity of boiler	
1. NA	Ton/hr
Type of Furnace	
1. NA	
Type of Fuel	
1. Diesel	4.6 KL/day

Regional Officer, Bahadurgarh
Haryana State Pollution Control Board.

Terms and conditions

1. The industry has declared that the quantity of effluent shall be 202 KL/Day i.e 0KL/Day for Trade Effluent, 0 KL/Day for Cooling, 202 KL/Day for Domestic and the same should not exceed .
2. The above 'Consent to Establish' is valid for 60 months from the date of its issue to be extended for another one year at the discretion of the Board or till the time the unit starts its trial production whichever is earlier. The unit will have to set up the plant and obtain consent during this period.
3. The officer/official of the Board shall have the right to access and inspection of the industry in connection with the various processes and the treatment facilities being provided simultaneously with the construction of building/machinery. The effluent should conform the effluent standards as applicable
4. That necessary arrangement shall be made by the industry for the control of Air Pollution before commissioning the plant. The emitted pollutants will meet the emission and other standards as laid/will be prescribed by the Board from time to time.
5. The applicant will obtain consent under section 25/26 of the Water (Prevention & Control of Pollution) Act, 1974 and under section 21/22 of the Air (Prevention & Control of Pollution) Act, 1981 as amended to-date-even before starting trial production
6. The above Consent to Establish is further subject to the conditions that the unit complies with all the laws/rules/decisions and competent directions of the Board/Government and its functionaries in all respects before commissioning of the operation and during its actual working strictly.
7. No in-process or post-process objectionable emission or the effluent will be allowed, if the scheme furnished by the unit turns out to be defective in any actual experience
8. The Electricity Department will give only temporary connection and permanent connection to the unit will be given after verifying the consent granted by the Board, both under Water Act and Air Act.
9. Unit will raise the stack height of DG Set/Boiler as per Board's norms.
10. Unit will maintain proper logbook of ~~Water~~ meter/sub meter before/after commissioning.

डॉ. दीप प्रकाश / Dr. Deep Prakash

11. That in the case of an industry or any other process the activity is located in an area approved and that in case the activity is sited in an residential or institutional or commercial or agricultural area, the necessary permission for siting such industry and process in an residential or institutional or commercial or agricultural area or controlled area under Town and Country Planning laws CLU or Municipal laws has to be obtained from the competent Authority in law permitting this deviation and be submitted in original with the request for consent to operate.
12. That there is no discharge directly or indirectly from the unit or the process into any interstate river or Yamuna River or River Ghaggar.
13. That the industry or the unit concerned is not sited within any prohibited distances according to the Environmental Laws and Rules, Notification, Orders and Policies of Central Pollution control Board and Haryana State Pollution Control Board.
14. That of the unit is discharging its sewage or trade effluent into the public sewer meant to receive trade effluent from industries etc. then the permission of the Competent Authority owing and operating such public sewer giving permission letter to his unit shall be submitted at time of consent to operate.
15. That if at any time, there is adverse report from any adjoining neighbor or any other aggrieved party or Municipal Committee or Zila Parishad or any other public body against the unit's pollution; the Consent to Establish so granted shall be revoked.
16. That all the financial dues required under the rules and policies of the Board have been deposited in full by the unit for this Consent to Establish.
17. In case of change of name from previous Consent to Establish granted, fresh Consent to Establish fee shall be levied.
18. Industry should adopt water conservation measures to ensure minimum consumption of water in their Process. Ground water based proposals of new industries should get clearance from Central Ground Water Authority for scientific development of previous resource.
19. That the unit will take all other clearances from concerned agencies, whenever required.
20. That the unit will not change its process without the prior permission of the Board.
21. That the Consent to Establish so granted will be invalid, if the unit falls in Aravali Area or non conforming area.
22. That the unit will comply with the Hazardous Waste Management Rules and will also make the non-leachate pit for storage of Hazardous waste and will undertake not to dispose off the same except for pit in their own premises or with the authorized disposal authority.
23. That the unit will submit an undertaking that it will comply with all the specific and general conditions as imposed in the above Consent to Establish within 30 days failing which Consent to Establish will be revoked.
24. That unit will obtain EIA from MoEF, if required at any stage.
25. In case of unit does not comply with the above conditions within the stipulated period, Consent to Establish will be revoked.
26. That unit will obtain consent to operate from the board before the start of product activity.

Specific Conditions

Other Conditions :

 डॉ. दीप प्रकाश / Dr. Deep Prakash
 परियोजना निदेशक / Project Director
 वैश्विक नाभिकीय ऊर्जा साझेदारी केंद्र (जी.सी.एन.ई.पी.)
 Global Centre for Nuclear Energy Partnership (G.C.N.E.P.)
 Government of India

1. CTE expansion is granted for full construction of the institutional campus and residential township including group housing as per the revised EC obtained by the unit from the date of approval till 03.04.2025 ie upto the validity of the EC with the condition that unit will comply with the conditions of Env Clearance granted to the unit.
2. The unit will install 03 no proposed STP's with total of 264.5 KLD capacity as mentioned in the EC.
3. The unit will install the DG set with inbuilt acoustic enclosures as mentioned in the EC.
4. The unit will submit the compliance reports to the concerned authorities on regular basis as mentioned in the EC granted to unit.
5. The unit will get renewed the License issued from T&CP deptt before expiry and will not do any construction during that period.
6. Unit will not operate without obtaining prior CTO from the board during validity period of CTE granted and installation of STP proposed for the expansion part.
7. Unit will comply with the MoEF Guidelines 2010 and Hon'ble NGT directions in regard to the orders passed in OA No. 21 of 2014 titled Vardhman Kaushik v
8. The project/unit will provide separate grey and black water should be done by the use of dual plumbing line. Treatment of 100% grey water by decentralized treatment should be done ensuring that the recycled water will be used for flushing, gardening and DG set cooling.
9. The solid waste generated should be properly collected and segregated as per the requirement of the MSW Rules, 2000 and as amended from time to time. The bio-degradable waste should be treated by appropriate technology at the site ear-marked within the project area and dry/inert solid waste should be disposed off to the approved sites for land filling after recovering recyclable material.
10. Ambient Noise level should be controlled to ensure that it does not exceed the prescribed standards both within and at the boundary of the proposed project.
11. Standards for discharging of environmental pollutants as enshrined in various schedules of rule 3 of Environment Protection Rules, 1986 shall be strictly complied with by the unit.
12. The unit will comply with the Construction & Demolition rules.

HARYANA STATE

SATINDER
PAL

Digitally signed by
SATINDER PAL
Date: 2018.10.03 11:58:40
+05'30'

Regional Officer, Bahadurgarh

Haryana State Pollution Control Board.

Deep Prakash

डॉ. दीप प्रकाश / Dr. Deep Prakash
परियोजना निदेशक / Project Director
वैश्विक नाभिकीय ऊर्जा साझेदारी केन्द्र (जी.सी.एन.ई.पी.)
Global Centre for Nuclear Energy Partnership (G.C.N.E.P.)
प.ऊ.वि., भारत सरकार / D.A.E., Government of India
बहादुरगढ़ (हरियाणा) / Bahadurgarh (Haryana) -124507

Annexure –II First aid Room



Prakash
डॉ. दीप प्रकाश / Dr. Deep Prakash
परियोजना निदेशक / Project Director
वैश्विक नाभिकीय ऊर्जा साझेदारी केन्द्र (जी.सी.एन.ई.पी.)
Global Nuclear Energy Partnership (G.N.E.P.)

ANNEXURE-III



Drinking Water

Dr. Deep Prakash

डॉ. दीप प्रकाश / Dr. Deep Prakash
परियोजना निदेशक / Project Director
वैश्विक नाभिकीय ऊर्जा साझेदारी केंद्र (जी.सी.एन.ई.पी.)
Global Centre for Nuclear Energy Partnership (G.C.N.E.P.)
प.ऊ.वि., भारत सरकार / D.A.E., Government of India
पृष्ठ संख्या / Page No. 24/507

SOLID WASTE MANAGEMENT PLAN

Solid waste would be generated both during the construction as well as during the operation phase. The solid waste expected to be generated during the construction phase will comprise of excavated materials, used bags, bricks, concrete, MS rods, tiles, wood etc. The following steps are proposed to be followed for the management solid waste:

- Construction yards are proposed for storage of construction materials.
- The excavated material such as topsoil and stones will be stacked for reuse during later stages of construction
- Excavated top soil will be stored in temporary constructed soil bank and will be reused for landscaping of the Residential Group Housing Colony project.
- Remaining soil shall be utilized for refilling / road work / rising of site level at locations/ selling to outside agency for construction of roads etc.

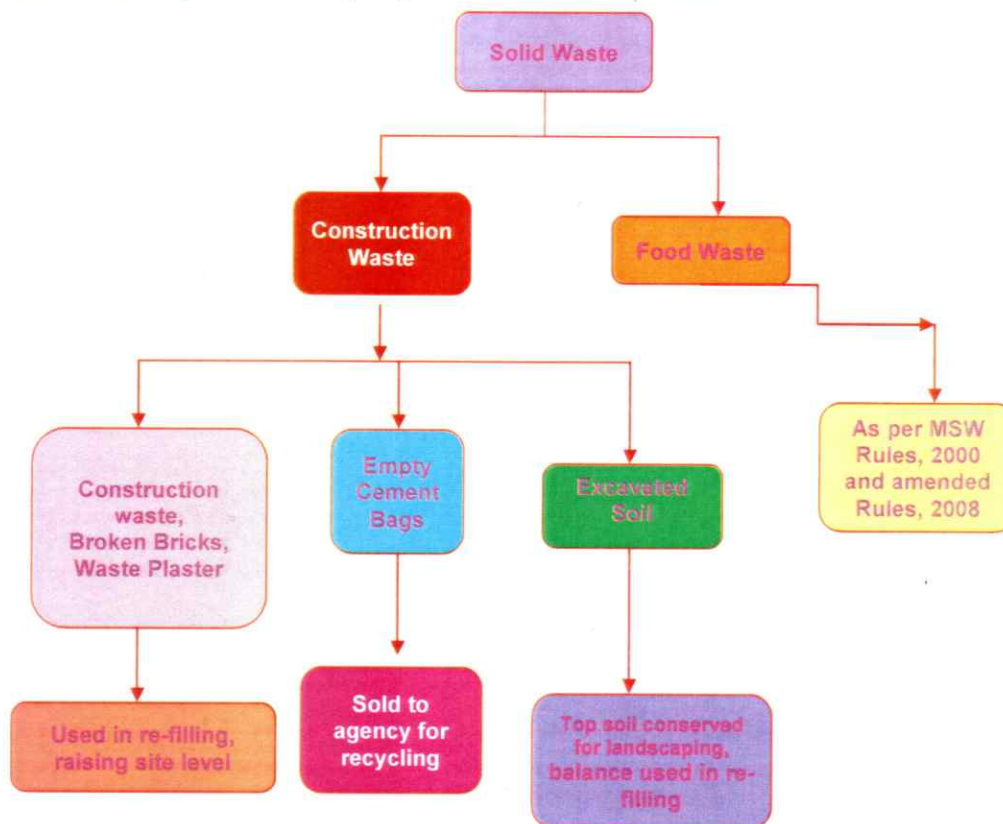

Figure 1: Solid Waste Management Scheme (Construction Phase)

During the operation phase, waste will comprise domestic as well as agricultural waste. The solid waste generated from the project shall be mainly domestic waste and estimated quantity

of the waste shall be approx. 1530 kg per day (@ 0.5 kg per capita per day for residents and students, @ 0.15 kg per capita per day for the visitor, 0.25 kg per capita per day for the staff members and landscape wastes @ 15 kg/acre/day). Following arrangements will be made at the site in accordance to Municipal Solid Wastes (Management and Handling) Rules, 2000 and amended Rules, 2008.

❖ **Collection and Segregation of waste**

1. A door to door collection system will be provided for collection of domestic waste in colored bins from household units.
2. The local vendors will be hired to provide separate colored bins for dry recyclables and Bio-Degradable waste.
3. For commercial waste collection, adequate number of colored bins (Green and Blue & dark grey bins– separate for Bio-degradable and Non Bio-degradable) are proposed to be provided at the strategic locations of the commercial area.
4. Litter bin will also be provided in open areas like parks etc.

❖ **Treatment of waste**

• **Bio-Degradable wastes**

1. Bio-degradable waste will be subjected to vermicomposting and the compost will be used as manure.
2. STP sludge is proposed to be used for horticultural purposes as manure.
3. Horticultural Waste is proposed to be composted and will be used for gardening purposes.

• **Recyclable wastes**

- i. **Grass Recycling** – The cropped grass will be spread on the green area. It will act as manure after decomposition.
- ii. Recyclable wastes like paper, plastic, metals etc. will be sold off to recyclables.

❖ **Disposal**

Recyclable and non-recyclable wastes will be disposed through Govt. approved agency. Hence, the Municipal Solid Waste Management will be conducted as per the guidelines of Municipal Solid Wastes (Management and Handling) Rules, 2000 and amended Rules, 2008. A Solid waste management Scheme is depicted in the following figure for the Residential Group Housing Colony Project.

 डॉ. दीप प्रकाश / Dr. Deep Prakash
 Project Director

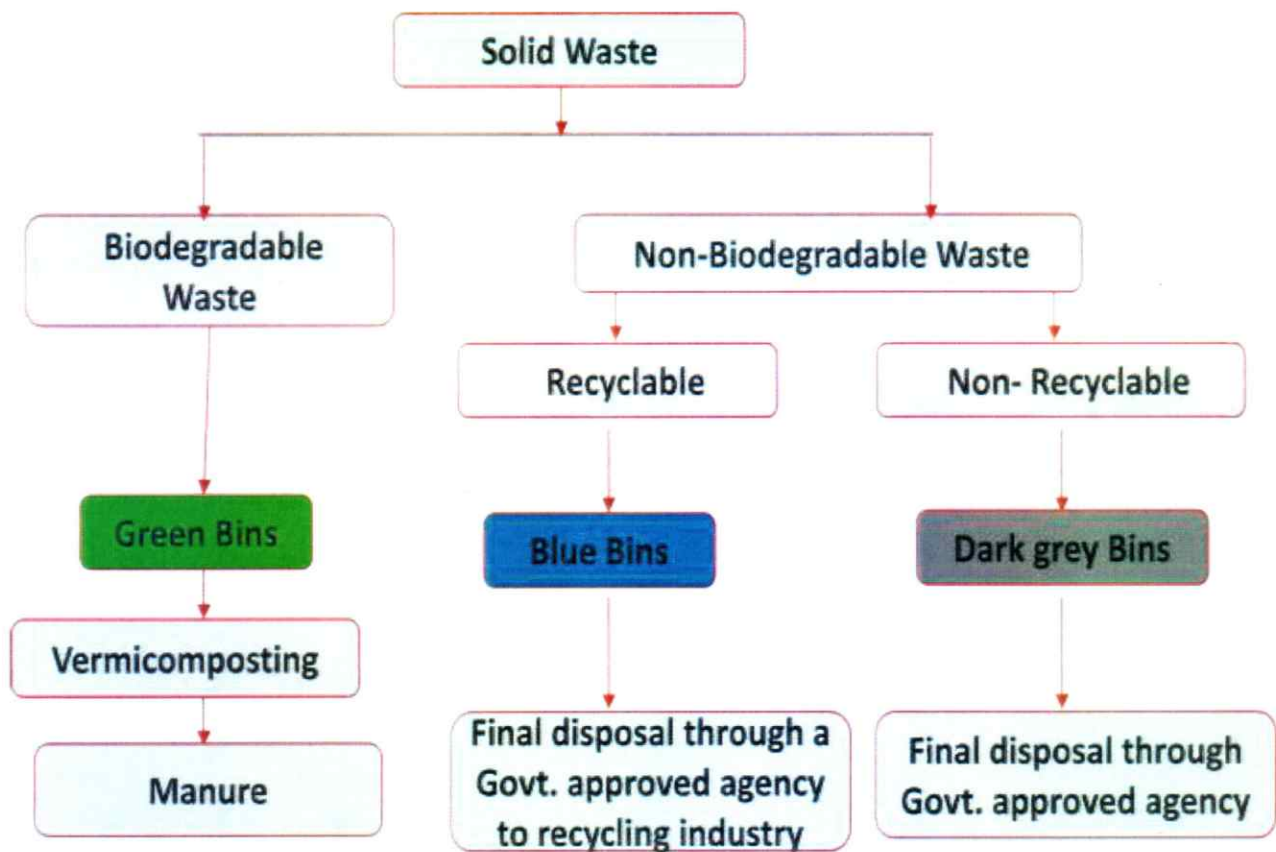

Figure 2: Solid Waste Management Scheme (Operation Phase)

Dr. Deep Prakash
 डॉ. दीप प्रकाश / Dr. Deep Prakash
 परियोजना निदेशक / Project Director
 वैश्विक नाभिकीय ऊर्जा साझेदारी केन्द्र (जी.सी.एन.ई.पी.)
 Global Centre for Nuclear Energy Partnership (G.C.N.E.P.)
 प.ऊ.वि., भारत सरकार / D.A.E., Government of India
 बहादुरगढ़ (हरियाणा) / Bahadurgarh (Haryana) -124507

ANNEXURE V: PHOTOGRAPH SHOWING STORAGE OF TOP SOIL



Prakash

डॉ. दीप प्रकाश / Dr. Deep Prakash
परियोजना निदेशक / Project Director
वैश्विक नाभिकीय ऊर्जा साझेदारी केन्द्र (जी.सी.एन.ई.पी.)
Global Centre for Nuclear Energy Partnership (G.C.N.E.P.)
Government of India

Annexure-VI COVERED CONSTRUCTION MATERIAL



Dr. Deep Prakash

डॉ. दीप प्रकाश / Dr. Deep Prakash
परियोजना निदेशक / Project Director
वैश्विक नाभिकीय ऊर्जा साझेदारी केन्द्र (जी.सी.एन.ई.पी.)
Global Centre for Nuclear Energy Partnership (G.C.N.E.P.)
प.ऊ.वि., भारत सरकार / D.A.E., Government of India
बहादुरगढ़ (हरियाणा) / Bahadurgarh (Haryana) -124507



Vardan EnviroLab

Laboratory: Plot No. 82A, Sector - 5, IMT Manesar, Gurugram - 122051 (Hr)
ISO 9001 | ISO 14001 | ISO 45001

AM NEXURE-011

Test Report

Sample Number: VEL/GCNEP/A/01
Name & Address of Party: M/s GCNEP, Department of Atomic Energy,
Government of India.
at Village- Kheri Jasaur and Jasaur Kheri,
Bhadurgarh, District- Jhajjar, Haryana

Report No.: VEL/A/2312/29/001
Format No.: 7.8F-03
Party Reference No.: NIL
Reporting Date: 02.01.2024
Period of Analysis: 29.12.2023 to 02.01.2024
Receipt Date: 29.12.2023

Sample Description : AMBIENT AIR QUALITY MONITORING

General Information:-

Sample collected by : VardanEnviro Lab Representative
Sampling Location : Project Site
Instrument Used : RDS & FPS sampler with all Accessories
Instrument Code : VEL/RDS/FPS/06
Instrument Calibration Status : Calibrated
Meteorological condition during monitoring : Clear Sky
Surrounding Activity : Human & Vehicular Activities
Scope of Monitoring : Regulatory Requirement
Control measure if Any : --
Sampling & Analysis Protocol : IS-5182
Parameter Required : PM_{2.5}, PM₁₀, NO₂, SO₂ CO, SPM, HC

Date	PM ₁₀ (µg/m ³)	PM _{2.5} (µg/m ³)	NO ₂ (µg/m ³)	SO ₂ (µg/m ³)	CO (mg/m ³)	SPM	HC (µg/m ³)
06.12.2023	122.30	77.85	25.63	9.78	0.69	160.2	**BDL (DL 0.05 µg/m ³)
07.12.2023	126.22	83.69	22.78	8.78	0.77	165.8	*BDL (DL 0.05 µg/m ³)
13.12.2023	110.78	56.47	17.85	12.36	0.92	148.3	**BDL (DL 0.05 µg/m ³)
14.12.2023	115.96	68.48	22.14	15.99	0.79	140.1	*BDL (DL 0.05 µg/m ³)
20.12.2023	96.48	73.65	20.36	11.52	0.89	130.7	**BDL (DL 0.05 µg/m ³)
21.12.2023	78.85	48.96	24.56	7.36	0.69	126.1	*BDL (DL 0.05 µg/m ³)
27.12.2023	82.65	55.85	23.62	9.85	0.66	135.0	**BDL (DL 0.05 µg/m ³)
28.12.2023	89.12	50.74	19.59	13.25	0.62	145.9	*BDL (DL 0.05 µg/m ³)

Limit as per NAAQS*	Parameter	PM ₁₀ (µg/m ³)	PM _{2.5} (µg/m ³)	NO ₂ (µg/m ³)	SO ₂ (µg/m ³)	CO (mg/m ³)
--	--	100	60	80	80	4

* National Ambient Air Quality Standards, Note - *Below Detection Limit.

(Checked By)



(Approved By)



Terms & Conditions

- The results reported relate only to the samples tested. In case sample is not drawn the results apply to the sample as received.
- This test report in full or in part, shall not be reproduced in any court of law without prior written approval of the laboratory.
- To confirm the authenticity of this certificate of analysis, please contact us through email at lab@vardan.co.in
- Laboratory is not responsible for the authenticity of photocopied test report. The test samples will be retained only for specific period

डॉ. दीप प्रकाश / Dr. Deep Prakash
परियोजना निदेशक / Project Director

वैश्विक नाभिकीय ऊर्जा साझेदारी केन्द्र (जी.सी.एन.ई.पी.)
Global Centre for Nuclear Energy Partnership (G.C.N.E.P.)
प.ऊ.वि., भारत सरकार / D.A.E., Government of India



Vardan EnviroLab

Laboratory: Plot No. 82A, Sector - 5, IMT Manesar, Gurugram - 122051 (Hr)
ISO 9001 | ISO 14001 | ISO 45001

Test Report

Sample Number: VEL/GCNEP/AN/01
Name & Address of Party: M/s GCNEP, Department of Atomic Energy, Government of India, Reactor Control Division, at Village- Kheri Jasaur and Jasaur Kheri, Bhadurgarh, District- Jhajjar, Haryana.
Report No.: VEL/AN/2312/08/001
Format No.: 7.8 F-03
Party Reference No.: NIL
Reporting Date: 12/12/2023
Period of Analysis: 08/12/2023 to 12/12/2023
Receipt Date: 08/12/2023
Sample Description : AMBIENT NOISE LEVEL MONITORING

General Information:-

Sample collected by : Vardan EnviroLab Representative
Sampling Location : Project Site
Instrument Used : Sound Level Meter
Instrument Calibration Status : Calibrated
Meteorological condition during monitoring : Clear Sky
Date of Monitoring : 06/12/2023 to 07/12/2023
Time of Monitoring : 06:00 AM to 06:00 AM
Surrounding Activity : Human & Vehicular Activities
Scope of Monitoring : Regulatory Requirement
Sampling & Analysis Protocol : IS-9989
Sampling Duration : 24 Hours
Parameter Required : L_{max} , L_{min} & L_{eq}

TEST RESULTS

S. No.	Parameters	Protocol	Test Result dB (A)		Unit
			Day Time (6:00 am to 10:00 pm)	Night Time (10:00 pm to 06:00 am)	
1.	L_{max}	IS-9989	65.4	58.6	dB(A)
2.	L_{min}	IS-9989	42.1	37.5	dB(A)
3.	L_{eq}	IS-9989	51.45	41.47	dB(A)
4.	CPCB Limits in dB(A) L_{eq} (Residential Area)	-	55.0	45.0	dB(A)

Note- *A "decibel" is a unit in which noise is measured.

(Checked By) 
GURGAON

(Approved By) 
Pratap Singh
Authorised Signatory

Terms & Conditions

- The results reported relate only to the samples tested. In case sample is not drawn the results apply to the sample as received.
- This test report in full or in part, shall not be reproduced in any court of law without prior written approval of the laboratory.
- To confirm the authenticity of this certificate of analysis, please contact us through email at lab@vardan.co.in
- Laboratory is not responsible for the authenticity of photocopied test report. The test samples will be retained only for specific period.
- The report no. with Suffix A-Amended Report.
- This test report will not be used for publicity or advertising or media purpose without prior written permission on the laboratory.

डॉ. दीप प्रकाश / Dr. Deep Prakash
परियोजना निदेशक / Project Director
वैश्विक नाभिकीय ऊर्जा साझेदारी केन्द्र (जी.सी.एन.ई.पी.)
Global Centre for Nuclear Energy Partnership (G.C.N.E.P.)
रू.वि., भारत सरकार / D.A.E., Government of India
बहादुरगढ़ (हरियाणा) / Bahadurgarh (Haryana) - 124507



Vardan EnviroLab

Laboratory: Plot No. 82A, Sector - 5, IMT Manesar, Gurugram - 122051 (Hr)
ISO 9001 | ISO 14001 | ISO 45001

Test Report

Sample Number: VEL/GCNEP/PN/01
Name & Address of Party: M/s GCNEP, Department of Atomic Energy,
Government of India
at Village- Kheri Jasaur and Jasaur Kheri,
Bhadurgarh, District- Jhajjar, Haryana.

Report No.: VEL/PN/2312/08/001
Format No.: 7.8 F-03
Party Reference No.: NIL
Reporting Date: 12/12/2023
Receipt Date: 08/12/2023

Sample Description : DG SET NOISE MONITORING

General Information:-

Sample collected by : Vardan EnviroLab Representative
Sampling Location : DG Area (250 KVA)
Instrument Used : Sound Level Meter
Instrument Calibration Status : Calibrated
Meteorological condition during monitoring : Clear Sky
Date of Monitoring : 06/12/2023
Time of Monitoring : 11:00 AM To 11:30 AM
Surrounding Activity : Human & Vehicular Activities
Scope of Monitoring : Regulatory Requirement
Control measure if Any : Acoustic enclosure
Sampling & Analysis Protocol : IS-4758
Sampling Duration : 30 Minutes
Parameter Required : Leq & Insertion Loss

S. No.	Parameters	Protocol	Open the Canopy of DG Set Result dB(A)	Close the Canopy of DG Set (0.5 Meter Distance) Result dB(A)	Insertion Loss
1.	L_{eq}	IS-4758	96.1	70.4	25.7
2.	CPCB Limit in dB(*A)	-	--	75.00	25.00

Note * A "decibel" is a unit in which noise is measured

(Checked By)



डॉ. दीप प्रकाश / Dr. Deep Prakash
परियोजना निदेशक / Project Director

वैश्विक नाभिकीय ऊर्जा साझेदारी केन्द्र (जी.सी.एन.ई.पी.)
Global Centre for Nuclear Energy Partnership (G.C.N.E.P.)
पू.ऊ.वि., भारत सरकार / D.A.E., Government of India
बहादुरगढ़ (हरियाणा) / Bahadurgarh (Haryana) - 124507

Terms & Conditions

- The results reported relate only to the samples tested. In case sample is not drawn the results apply to the sample as received.
- This test report in full or in part, shall not be reproduced in any court of law without prior written approval of the laboratory.
- To confirm the authenticity of this certificate of analysis, please contact us through email at lab@vardan.co.in
- Laboratory is not responsible for the authenticity of photocopied test report. The test samples will be retained only for specific period.
- The report no. with Suffix A-Amended Report.
- This test report will not be used for publicity or advertising or media purpose without prior written permission on the laboratory.



Vardan EnviroLab

Laboratory: Plot No. 82A, Sector - 5, IMT Manesar, Gurugram - 122051 (Hr)
ISO 9001 | ISO 14001 | ISO 45001

Test Report

Sample Number: VEL/GCNEP/ST/01
Name & Address of Party: M/s GCNEP, Department of Atomic Energy,
Government of India
at Village- Kheri Jasaur and Jasaur Kheri,
Bhadurgarh, District- Jhajjar, Haryana

Report No.: VEL/ST/2312/08/001
Format No.: 7.8 F-03
Party Reference No.: NIL
Reporting Date: 12/12/2023
Period of Analysis: 08/12/2023 to 12/12/2023
Receipt Date: 08/12/2023

Sample Description : STACK EMISSION MONITORING

Sample Collected : Vardan EnviroLab Team
Date of Sampling : 06/12/2023
Sampling Location : DG Area (250 KVA)
Sampling duration (Minutes) : 40.0
Meteorological Condition : Clear Sky
Height of the Stack : 7.62 Meter
Diameter of the Stack : 0.15 mtr
Instrument calibration status : Calibrated
Ambient Temperature - Ta (°C) : 22.0
Temperature of Stack Gases - Ts (°C) : 134.0
Velocity of Stack Gases (m/sec.) : 7.85
Flow rate of PM (LPM) : 25.0
Flow rate of Gas (LPM) : 2.0
Sampling condition : Isokinetic
Protocol used : IS:11255

TEST RESULTS

S. No.	Parameters	Protocol	Units	Results	Limits (As Per CPCB)
1.	Particulate Matter (PM)	IS 11255 (P-1), Gravimetric Method	g/kW - hr	0.18	≤ 0.2
2.	Nitrogen Dioxide (as NO ₂)	IS 11255 (P-7)	g/kW - hr	0.361	≤ 4.0
3.	Total Hydrocarbon as Methane	VEL/ENV/STP/ST/FGA/01, Issue No.- 01.01/11/21	g/kW - hr	0.14	≤ 3.5
4.	Carbon Monoxide (as CO)	VEL/ENV/STP/ST/FGA/01, Issue No.- 01.01/11/21	g/kW - hr	0.372	≤ 3.5
5.	Sulphur Dioxide (as SO ₂)	IS: 11255 (P-2), Titrimetric Method	gm/Kw-hr	0.261	--

* SOP-Laboratory Standard operating procedure.

(Checked By)



Dr. Deep Prakash



Terms & Conditions

- The results reported relate only to the samples tested. In case sample is not drawn the results apply to the sample as received.
- This test report in full or in part, shall not be reproduced in any court of law without prior written approval of the laboratory.
- To confirm the authenticity of this certificate of analysis, please contact us through email at lab@vardan.co.in
- Laboratory is not responsible for the authenticity of photocopied test report. The test samples will be retained only for specific period.
- The report no. with Suffix A-Amended Report.

डॉ. दीप प्रकाश / Dr. Deep Prakash
परियोजना निदेशक / Project Director
वैश्विक नाभिकीय ऊर्जा साझेदारी केन्द्र (जी.सी.एन.ई.पी.)
Global Centre for Nuclear Energy Partnership (G.C.N.E.P.)
भारत सरकार / D.A.E., Government of India
प.क.वि., बहादुरगढ़ (हरियाणा) / Bahadurgarh (Haryana) - 124507



Vardan EnviroLab

Laboratory: Plot No. 82A, Sector - 5, IMT Manesar, Gurugram - 122051 (Hr)
ISO 9001 | ISO 14001 | ISO 45001

Test Report

Sample Number: VEL/GCNEP/S/01
Name & Address of Party: M/s GCNEP, Department of Atomic Energy,
Government of India,
at Village- Kheri Jasaur and Jasaur Kheri,
Bhadurgarh, District- Jhajjar, Haryana.

Report No.: VEL/S/2312/08/001
Format No.: 7.8 F-03
Party Reference No.: NIL
Reporting Date: 12/12/2023

Sample Description: SOIL
Sampling Location: School Building Area
Sample Collected by: Vardan Enviro Lab Representative
Sampling & Analysis Protocol: I IS 2720 & STP

Period of Analysis: 08/12/2023 to 12/12/2023
Receipt Date: 08/12/2023
Sampling Date: 06/12/2023
Type of Sampling: Composite
Sampling Quantity: 2.0 Kg
Packing Status: Temp Sealed

S. No.	Parameter	Test-Method	Result	Unit
1.	pH (at 25 °C)	IS : 2720 (P-26)	7.48	--
2.	Conductivity	IS:14767	0.325	mS/cm
3.	Soil Texture	VEL/STP/EN/64, Issue No.- 01, 01/11/2021	Sandy loam	--
4.	Color	VEL/STP/EN/67, Issue No.- 01, 01/11/2021	Yellowish Brown	--
5.	Water holding capacity	VEL/STP/EN/86, Issue No.- 01, 01/11/2021	30.12	%
6.	Bulk density	VEL/STP/EN/59, Issue No.- 01, 01/11/2021	1.68	gm/cc
7.	Chloride as Cl	VEL/STP/EN/69, Issue No.- 01, 01/11/2021	48.78	mg/100g
8.	Calcium as Ca	VEL/STP/EN/72, Issue No.- 01, 01/11/2021	59.12	mg/100g
9.	Sodium as Na	VEL/STP/EN/62, Issue No.- 01, 01/11/2021	69.74	mg/kg
10.	Potassium as K	VEL/STP/EN/61, Issue No.- 01, 01/11/2021	115.20	kg/hect.
11.	Organic Matter	IS 2720 (P-22), Titrimetric Method	0.49	%
12.	Magnesium as Mg	VEL/STP/EN/72, Issue No. 01, 01/11/2021	20.12	mg/100g
13.	Available Nitrogen as N	IS:14684 Distillation Method	155.79	kg./hect.
14.	Available Phosphorus	VEL/STP/EN/73, Issue No.- 01, 01/11/2021	35.17	kg./hect.
15.	Zinc (as Zn)	STP NO. VEL/STP/EN/165, Issue No.- 01, 20/06/22	10.85	mg/kg
16.	Manganese (as Mn)	STP NO. VEL/STP/EN/165, Issue No.- 01, 20/06/22	1.89	mg/kg
17.	Lead (as Pb)	STP NO. VEL/STP/EN/165, Issue No.- 01, 20/06/22	0.62	mg/kg
18.	Cadmium (as Cd)	STP NO. VEL/STP/EN/165, Issue No.- 01, 20/06/22	0.72	mg/kg
19.	Chromium (as Cr)	STP NO. VEL/STP/EN/165, Issue No.- 01, 20/06/22	0.48	mg/kg
20.	Copper (as Cu)	STP NO. VEL/STP/EN/165, Issue No.- 01, 20/06/22	1.10	mg/kg

SOP-Laboratory standard operating procedure.

(Checked By)



Terms & Conditions

- The results reported relate only to the samples tested. In case sample is not drawn the results apply to the sample as received.
- This test report in full or in part, shall not be reproduced in any court of law without prior written approval of the laboratory.
- To confirm the authenticity of this certificate of analysis, please contact us through email at lab@vardan.co.in
- Laboratory is not responsible for the authenticity of photocopied test report. The test samples will be retained only for specific period.
- The report no. with Suffix A-Amended Report.
- This test report will not be used for publicity or advertising or media purpose without prior written permission on the laboratory.
- Client's signature does not imply endorsement of the testing sample by the lab. Under no circumstances, the lab accepts any liability caused by the use or misuse of the test report.

डॉ. दीप प्रकाश / Dr. Deep Prakash
परियोजना निदेशक / Project Director
वैश्विक नाभिकीय ऊर्जा साझेदारी केंद्र (जी.सी.एन.ई.पी.)
Global Centre for Nuclear Energy Partnership (G.C.N.E.P.)
प.ऊ.वि., भारत सरकार / D.A.E., Government of India
बहादुरगढ़ (हरियाणा) / Bahadurgarh (Haryana) - 124507



Vardan EnviroLab

Laboratory: Plot No. 82A, Sector - 5, IMT Manesar, Gurugram - 122051 (Hr)
ISO 9001 | ISO 14001 | ISO 45001

Test Report

Sample Number: VEL/GCNEP/W/01
Name & Address of Party: M/s GCNEP, Department of Atomic Energy, Government of India, at Village- Kheri Jasaur and Jasaur Kheri, Bhadurgarh, District- Jhajjar, Haryana.
Sample Description: Drinking Water Sample
Sampling Location: Office Area
Sample Collected by: VardanEnviro Lab Representative
Sampling & Analysis Protocol: IS:3025 & APHA, 23rd Edt.2017

Report No.: VEL/W/2312/08/001
Format No.: 7.8 F-03
Party Reference No.: NIL
Reporting Date: 12/12/2023

Period of Analysis: 08/12/2023 to 12/12/2023
Receipt Date: 08/12/2023
Sampling Date: 06/12/2023
Sampling Quantity: 2.0 Ltr + 250 ml

Sampling Type: Grab
Preservation: Ice Box
Parameter Required: As per Work Order

S. No.	Parameter	Test-Method	Result	Unit	Limits of IS:10500 -2012	
					Requirement (Acceptable Limit)	Permissible limit in the Absence of Alternate Source
1.	pH (at 25 °C)	IS3025 (P-11)	7.42	--	6.5 to 8.5	No Relaxation
2.	Colour	IS3025 (P-4)	BLQ(LOQ-1.0)	Hazen	5	15
3.	Turbidity	IS3025 (P-10)	BLQ(LOQ-1.0)	NTU	1	5
4.	Odour	IS3025 (P-5)	Agreeable	--	Agreeable	Agreeable
5.	Taste	IS3025 (P-8)	Agreeable	--	Agreeable	Agreeable
6.	Total Hardness (as CaCO ₃)	IS3025 (P-21)	60.84	mg/l	200	600
7.	Calcium (as Ca)	IS3025 (P-40)	14.73	mg/l	75	200
8.	Alkalinity (as CaCO ₃)	IS3025 (P-23)	45.08	mg/l	200	600
9.	Chloride (as Cl)	IS 3025 (P-32)	13.94	mg/l	250	1000
10.	Cyanide (as CN)	IS 3025 (P-27)	BLQ(LOQ-0.02)	mg/l	0.05	No Relaxation
11.	Magnesium (as Mg)	IS3025 (P-46)	5.85	mg/l	30	100
12.	Total Dissolved Solids	IS3025 (P-16)	125.00	mg/l	500	2000
13.	Sulphate(as SO ₄)	IS3025 (P-24)	6.86	mg/l	200	400
14.	Fluoride (as F)	IS 3025 (P-60)	BLQ(LOQ-0.2)	mg/l	1.0	1.5
15.	Nitrate (as NO ₃)	IS3025 (P-34)	BLQ(LOQ-1.0)	mg/l	45	No Relaxation
16.	Iron (as Fe)	VEL/STP/ICP/W-01, Issue No.-01, 01/11/21	BLQ(LOQ-0.01)	mg/l	1.0	No relaxation
17.	Aluminum (as Al)	VEL/STP/ICP/W-01, Issue No.-01, 01/11/21	BLQ(LOQ-0.002)	mg/l	0.03	0.2
18.	Boron	VEL/STP/ICP/W-01, Issue No.-01, 01/11/21	BLQ(LOQ-0.01)	mg/l	0.5	2.4
19.	Total Chromium (as Cr)	VEL/STP/ICP/W-01, Issue No.-01, 01/11/21	BLQ(LOQ-0.01)	mg/l	0.05	No Relaxation

(Checked By)

Terms & Conditions

- The results reported relate only to the samples tested. In case sample is not drawn the results apply to the sample as received.
- This test report in full or in part, shall not be reproduced in any court of law without prior written approval of the laboratory.
- To confirm the authenticity of this certificate of analysis, please contact us through email at lab@vardan.co.in
- Laboratory is not responsible for the authenticity of photocopied test report. The test samples will be retained only for specific period.
- The report no. with Suffix A-Amended Report.
- This test report will not be used for publicity or advertising or media purpose without prior written permission on the laboratory.
- Giving opinions does not imply endorsement of the tested sample by the lab. Under no circumstances, the lab accepts any liability caused by the use or misuse of the test report.

डॉ. दीप प्रकाश / Dr. Deep Prakash
परियोजना निदेशक / Project Director

वैश्विक नाभिकीय ऊर्जा साझेदारी केंद्र (जी.सी.एन.ई.पी.)
Global Centre for Nuclear Energy Partnership (G.C.N.E.P.)
प.ऊ.वि., भारत सरकार / D.A.E., Government of India
बहादुरगढ़ (हरियाणा) / Bahadurgarh (Haryana) - 124307



Vardan EnviroLab

Laboratory: Plot No. 82A, Sector - 5, IMT Manesar, Gurugram - 122051 (Hr)
ISO 9001 | ISO 14001 | ISO 45001

Test Report

Sample No.: VEL/GCNEP/W/01

Report No: VEL/W/2312/08/001

S. No	Parameter	Test-Method	Result	Unit	Limits of IS:10500-2012	
					Requirement (Acceptable) Limit	Permissible limit in the Absence of Alternate Source
1.	Phenolic Compounds	IS3025 (P-43)	BLQ(LOQ-0.0005)	mg/l	0.001	0.002
2.	Mineral Oil	IS 3025 (P-39)	BLQ(LOQ-0.1)	mg/l	1.0	No Relaxation
3.	Anionic Detergents (as MBAS)	IS3025 (P-68)	BLQ(LOQ-0.05)	mg/l	0.2	1.0
4.	Zinc (as Zn)	VEL/STP/ICP/W-01, Issue No.-01, 01/11/21	BLQ(LOQ-0.01)	mg/l	5	15
5.	Copper (as Cu)	VEL/STP/ICP/W-01, Issue No.-01, 01/11/21	BLQ(LOQ-0.002)	mg/l	0.05	1.5
6.	Manganese (as Mn)	VEL/STP/ICP/W-01, Issue No.-01, 01/11/21	BLQ(LOQ-0.01)	mg/l	0.1	0.3
7.	Cadmium (as Cd)	VEL/STP/ICP/W-01, Issue No.-01, 01/11/21	BLQ(LOQ-0.002)	mg/l	0.003	No Relaxation
8.	Lead (as Pb)	VEL/STP/ICP/W-01, Issue No.-01, 01/11/21	BLQ(LOQ-0.002)	mg/l	0.01	No Relaxation
9.	Selenium (as Se)	VEL/STP/ICP/W-01, Issue No.-01, 01/11/21	BLQ(LOQ-0.001)	mg/l	0.01	No Relaxation
10.	Arsenic (as As)	VEL/STP/ICP/W-01, Issue No.-01, 01/11/21	BLQ(LOQ-0.005)	mg/l	0.01	No Relaxation
11.	Mercury (as Hg)	VEL/STP/ICP/W-01, Issue No.-01, 01/11/21	BLQ(LOQ-0.0005)	mg/l	0.001	No Relaxation

(Checked By)



Dr. Deep Prakash
परियोजना निदेशक / Project Director
वैश्विक नाभिकीय ऊर्जा साझेदारी केन्द्र (जी.सी.एन.ई.पी.)
Global Centre for Nuclear Energy Partnership (G.C.N.E.P.)
प.ऊ.वि., भारत सरकार / D.A.E., Government of India
बहादुरगढ़ (हरियाणा) / Bahadurgarh (Haryana) - 124507

Terms & Conditions

- The results reported relate only to the samples tested. In case sample is not drawn the results apply to the sample as received.
- This test report in full or in part, shall not be reproduced in any court of law without prior written approval of the laboratory.
- To confirm the authenticity of this certificate of analysis, please contact us through email at lab@vardan.co.in
- Laboratory is not responsible for the authenticity of photocopied test report. The test samples will be retained only for specific period
- The report no. with Suffix A-Amended Report.
- This test report will not be used for publicity or advertising or media purpose without prior written permission on the laboratory.



Vardan EnviroLab

Laboratory: Plot No. 82A, Sector - 5, IMT Manesar, Gurugram - 122051 (Hr)
ISO 9001 | ISO 14001 | ISO 45001

Test Report

Sample No.: VEL/GCNEP/W/01

Report No: VEL/W/2312/08/001

S. No.	Parameter	Test-Method	Result	Unit	Limits of IS:10500 -2012	
					Requirement (Acceptable Limit)	Permissible limit in the Absence of Alternate Source
1.	Total Coliform	IS 15185	Absent	/100ml	Shall not be Detectable in any 100 ml Sample	-
2.	E. Coli	IS 15195	Absent	/100ml	Shall not be Detectable in any 100 ml Sample	-

Note:-This Report Complies as per IS: 10500:2012 (RA: 2018)

*BLQ-Below Limit of Quantification, **LOQ- Limit of Quantification.

¹Amendment No.1 in June 2015 (Limits of Iron & Arsenic) and Amendment No.2 in Sept. 2018 (Limit of Boron & IS method of Total Coliform & E.Coli) & Amendment No.3 in Feb. 2021 (Limit of Mineral Oil).

End of Report



(Checked By)

Dr. Deep Prakash



(Approved By)

डॉ. दीप प्रकाश / Dr. Deep Prakash
परियोजना निदेशक / Project Director

वैश्विक नाभिकीय ऊर्जा साझेदारी केन्द्र (जी.सी.एन.ई.पी.)
Global Centre for Nuclear Energy Partnership (G.C.N.E.P.)

प.ऊ.वि., भारत सरकार / D.A.E., Government of India
बहादुरगढ़ (हरियाणा) / Bahadurgarh (Haryana)-124507

Terms & Conditions

- The results reported relate only to the samples tested. In case sample is not drawn the results apply to the sample as received.
- This test report in full or in part, shall not be reproduced in any court of law without prior written approval of the laboratory.
- To confirm the authenticity of this certificate of analysis, please contact us through email at lab@vardan.co.in
- Laboratory is not responsible for the authenticity of photocopied test report. The test samples will be retained only for specific period
- The report no. with Suffix A-Amended Report.
- This test report will not be used for publicity or advertising or media purpose without prior written permission on the laboratory.



Vardan EnviroLab

Laboratory: Plot No. 82A, Sector - 5, IMT Manesar, Gurugram - 122051 (Hr)
ISO 9001 | ISO 14001 | ISO 45001

Test Report

Sample Number:	VEL/GCNEP/WW/01	Report No.:	VEL/WW/2312/08/001
Name & Address of the Project:	M/s GCNEP, Department of Atomic Energy, Government of India, at Village- Kheri Jasaur and Jasaur Kheri, Bhadurgarh, District- Jhajjar, Haryana	Format No.:	7.8 F-03
		Party Reference No.:	NIL
Sample Description:	Waste Water (STP Inlet)	Reporting Date:	12/12/2023
Sampling Location:	STP Plant	Period of Analysis:	08/12/2023 to 12/12/2023
Sample Collected By:	Vardan EnviroLab Representative	Receipt Date:	08/12/2023
Parameter Required:	As per Work Order	Sampling Date:	06/12/2023
		Sampling Quantity:	2.0 Ltr
		Analysis Protocol:	IS 3025 & APHA 23 rd Edition
		Preservation:	Ice Box

S. No.	Parameter	Test-Method	Result	Unit
1.	pH (at 25 °C)	IS:3025 (P-11):2022	6.84	--
2.	Total Suspended Solids	IS: 3025 (P-14) (Gravimetric)	289.00	mg/l
3.	Total Nitrogen	IS:3025 (P-34)	22.4	mg/l
4.	BOD (.3 Days at 27°C)	IS 3025 (Part-44)	520.00	mg/l
5.	COD	APHA, 5220 B Open Reflux Method:2017	148.00	mg/l
6.	Total Phosphate (as PO ₄)	IS 3025 (P-31) Sec:1 : 2022 (Stannous Chloride Method)	1.62	mg/l
7.	Faecal Coliform	IS 1622:1981 (RA-2019)	900	mg/l



Dr. Deep Prakash

डॉ. दीप प्रकाश / Dr. Deep Prakash
परियोजना निदेशक / Project Director
वैश्विक नाभिकीय ऊर्जा साझेदारी केन्द्र (जी.सी.एन.ई.पी.)
Global Centre for Nuclear Energy Partnership (G.C.N.E.P.)
प.ऊ.वि., भारत सरकार / D.A.E., Government of India
बहादुरगढ़ (हरियाणा) / Bahadurgarh (Haryana) -124507

Terms & Conditions

- The results reported relate only to the samples tested. In case sample is not drawn the results apply to the sample as received.
- This test report in full or in part, shall not be reproduced in any court of law without prior written approval of the laboratory.
- To confirm the authenticity of this certificate of analysis, please contact us through email at lab@vardan.co.in
- Laboratory is not responsible for the authenticity of photocopied test report. The test samples will be retained only for specific period
- The report no. with Suffix A-Amended Report.
- This test report will not be used for publicity or advertising or media purpose without prior written permission on the laboratory.
- Giving opinions does not imply endorsement of the tested sample by the lab. Under no circumstances, the lab accepts any liability caused by the use or misuse of the test report.





Vardan EnviroLab

Laboratory: Plot No. 82A, Sector - 5, IMT Manesar, Gurugram - 122051 (Hr)
ISO 9001 | ISO 14001 | ISO 45001

Test Report

Sample Number:	VEL/GCNEP/WW/02	Report No.:	VEL/WW/2312/08/002
Name & Address of the Project:	M/s GCNEP, Department of Atomic Energy, Government of India, at Village- Kheri Jasaur and Jasaur Kheri, Bhadurgarh, District- Jhajjar, Haryana	Format No.:	7.8 F-03
		Party Reference No.:	NIL
Sample Description:	Waste Water (STP Outlet)	Reporting Date:	12/12/2023
Sampling Location:	STP Plant	Period of Analysis:	08/12/2023 to 12/12/2023
Sample Collected By:	Vardan EnviroLab Representative	Receipt Date:	08/12/2023
Parameter Required:	As per Work Order	Sampling Date:	06/12/2023
		Sampling Quantity:	2.0 Ltr
		Analysis Protocol:	IS 3025 & APHA 23 rd Edition
		Preservation:	Ice Box

S. No.	Parameter	Test-Method	Result	Unit	Prescribed Limits*
1.	pH (at 25 °C)	IS:3025 (P-11):2022	7.52	--	5.5-9.0
2.	Total Suspended Solids	IS: 3025 (P-14) (Gravimetric)	7.00	mg/l	20.0
3.	Total Nitrogen	IS:3025 (P-34)	1.65	mg/l	10.0
4.	BOD (.3 Days at 27°C)	IS 3025 (Part-44)	8.7	mg/l	10.0
5.	COD	APHA, 5220 B Open Reflux Method:2017	34.00	mg/l	50.0
6.	Total Phosphate (as PO ₄)	IS 3025 (P-31) Sec:1 : 2022 (Stannous Chloride Method)	BLQ(LOQ-0.6)	mg/l	--
7.	Feacal Coliform	IS 1622:1981 (RA-2019)	60	MPN/100ml	--



Dr. Deep Prakash

डॉ. दीप प्रकाश / Dr. Deep Prakash
परियोजना निदेशक / Project Director
वैश्विक नाभिकीय ऊर्जा साझेदारी केन्द्र (जी.सी.एन.ई.पी.)
Global Centre for Nuclear Energy Partnership (G.C.N.E.P.)
प.ऊ.वि., भारत सरकार / D.A.E., Government of India
बहादुरगढ़ (हरियाणा) / Bahadurgarh (Haryana) -124507



Terms & Conditions

- The results reported relate only to the samples tested. In case sample is not drawn the results apply to the sample as received.
- This test report in full or in part, shall not be reproduced in any court of law without prior written approval of the laboratory.
- To confirm the authenticity of this certificate of analysis, please contact us through email at lab@vardan.co.in
- Laboratory is not responsible for the authenticity of photocopied test report. The test samples will be retained only for specific period
- The report no. with Suffix A-Amended Report.
- This test report will not be used for publicity or advertising or media purpose without prior written permission on the laboratory.
- Giving opinions does not imply endorsement of the tested sample by the lab. Under no circumstances, the lab accepts any liability caused by the use or misuse of the test report.

ANNEXURE VIII

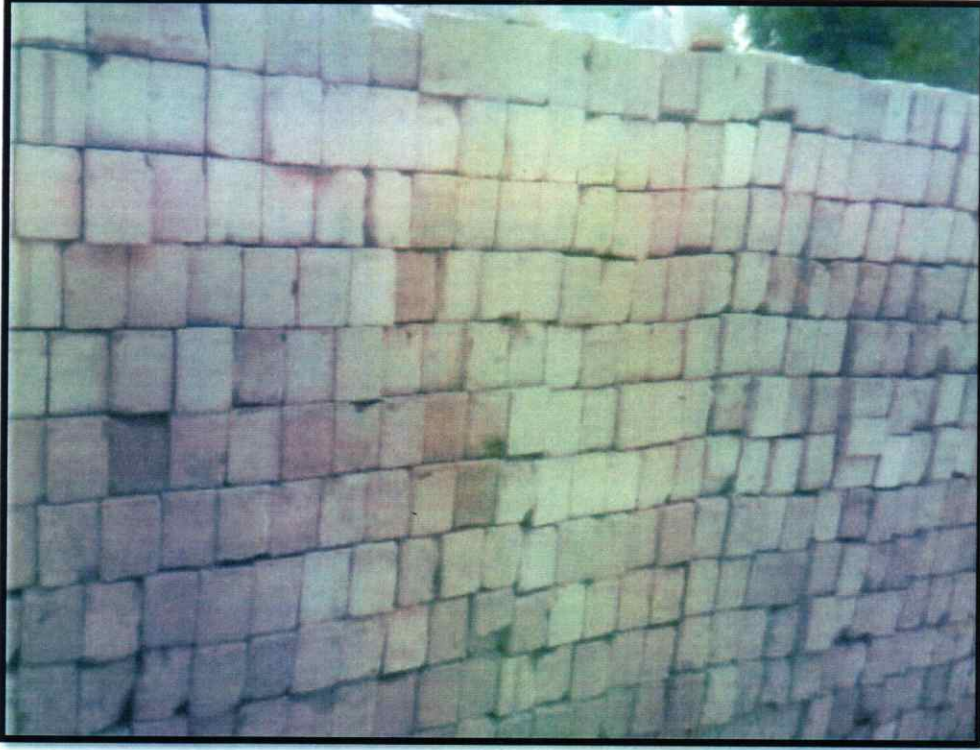

Dr. Deep Prakash

डॉ. दीप प्रकाश / Dr. Deep Prakash
परियोजना निदेशक / Project Director
वैश्विक नाभिकीय ऊर्जा साझेदारी केन्द्र (जी.सी.एन.ई.पी.)
Global Centre for Nuclear Energy Partnership (G.C.N.E.P.)
प.ऊ.वि., भारत सरकार / D.A.E., Government of India
बहादुरगढ़ (हरियाणा) / Bahadurgarh (Haryana) -124507

ANNEXURE IX



Cement storage



Batching Plant

Dr. Deep Prakash

डॉ. दीप प्रकाश / Dr. Deep Prakash
परियोजना निदेशक / Project Director
वैश्विक नाभिकीय ऊर्जा साझेदारी केन्द्र (जी.सी.एन.ई.पी.)
Global Centre for Nuclear Energy Partnership (G.C.N.E.P.)
प.ऊ.वि., भारत सरकार / D.A.E., Government of India
बहादुरगढ़ (हरियाणा) / Bahadurgarh (Haryana) -124507

CAMPUS SITE			
Sr. No.	Load Description	Connected Load (CL) in kVA	Maximum Demand (MD) in kVA
1.	Central building	1500	750
2.	SARRT	673	150
3.	SNMCS	192	150
4.	SNSS	591	450
5.	SANESS	2000	800
6.	SANESS High Bay	2000	800
7.	SRSS	1500	450
8.	HVAC	3000	2400
9.	Domestic and flushing Panel	75	40
10.	Firefighting Panel	160	160
11.	STP	150	100
12.	Pump Room	200	100
13.	External Road Lighting	15	15
	Total	12056	6365
	TOTAL LOAD (WITH DIVERSITY) 80%		5092
	SAY		5000 kVA

डॉ. दीप प्रकाश / Dr. Deep Prakash
 परियोजना निदेशक / Project Director
 वैश्विक नाभिकीय ऊर्जा साझेदारी केन्द्र (जी.सी.एन.ई.पी.)
 Global Centre for Nuclear Energy Partnership (G.C.N.E.P.)
 प.ऊ.वि., भारत सरकार / D.A.E., Government of India
 बहादुरगढ़ (हरियाणा) / Bahadurgarh (Haryana) -124507

Details of Saving in Electrical Energy in GCNEP Campus & Township by employing Energy Saving devices.

Sr. No.	With out Energy Saving Measures			With Energy Saving Measures			Energy Saved		Remarks
	Load Description	Load (kW)	Energy Consumed (kWh)	Load Description	Load (kW)	Energy Consumed (kWh)	in kWh	% Saving	
1	2	3	4	5	6	7	8	9	10
I)	CAMPUS								
1	T8 Fluorescent light fixtures	384 (8000 pts) @ 8 hrs per day	3072	T5- Fluorescent light fixtures	248	1984 @ 8 hrs per day	1088	35%	1) 8 Hours operation assumed 2) T8 - 36W lamp with electromagnetic ballast (12W) 3) T5- 28W lamp with electronic ballast (3W)
2	Water heater load	10	60 @ 6 hrs per day	Solar Water Heater	5	30 @ 6 hrs per day	30	50%	
3	Streetlighting with SON-T (HPSV) lamp	15	180 @ 12 hrs per day	Streetlighting with LED (50 W) fixture	5	60 @ 12 hrs per day	120	67%	

डॉ. दीप प्रकाश / Dr. Deep Prakash
 परियोजना निदेशक / Project Director
 वैश्विक नाभिकीय ऊर्जा साझेदारी केंद्र (जी सी एन ई पी)
 Global Centre for Nuclear Energy Partnership (GCNEP)
 पृष्ठ 12, सार सक्कर / D.A.E., Government of India
 बहादुरगढ़ (हरियाणा) / Bahadurgarh (Haryana) -124507

Sr. No.	With out Energy Saving Measures			With Energy Saving Measures			Energy Saved		
	Load Description	Load (kW)	Energy Consumed (kWh)	Load Description	Load (kW)	Energy Consumed (kWh)	in kWh	% Saving	Remarks
1	2	3	4	5	6	7	8	9	10
II)									
1	T8 Fluorescent light fixtures	124 (2600 pts)	992	T5- Fluorescent light fixtures	80	640	352	35%	1) 8 Hours operation assumed 2) T8 - 36W lamp with electromagnetic ballast (12W) 3) T5- 28W lamp with electronic ballast (3W)
2	Water heater load	54	54	Solar Water Heater	25	25	29	54%	
3	Streetlighting with SON-T (HPSV) lamp	15	180	Streetlighting with LED (50 W) fixture	5	60	120	67%	

Total Energy Saved per day = 1739 kWh

- Note:
- 1) The proposed use of Energy efficient LED luminaires for interior lighting will further result in savings up to 40% compared to conventional T-5 fluorescents lamps.
 - 2) The proposed use of roof top grid tied solar PV system will further reduce the energy demand by generation of approx. 5400 units per day considering 6 hours of sunlight.

डॉ. दीप प्रकाश / Dr. Deep Prakash
 परियोजना निदेशक / Project Director
 वैश्विक नाभिकीय ऊर्जा साझेदारी केन्द्र (जी.सी.एन.ई.पी.)
 Global Centre for Nuclear Energy Partnership (G.C.N.E.P.)
 प.ऊ.वि., भारत सरकार / D.A.E., Government of India
 बहादुरगढ़ (हरियाणा) / Bahadurgarh (Haryana) -124507

वन मण्डल अधिकारी (क्षेत्रीय), झज्जर

बाग जौहारा स्टेडियम, नजदीक DSP Residence, झज्जर
दूरभाष 01251-257258 e-mail:- dfojajjar@yahoo.co.in, dfojajjar@rediffmail.com

सेवा में:-

Ms. Y.S. Mayya, OS
Project Director, GCNEP
(Global Centre for Nuclear Energy Partnership),
DAE, Govt. of India,
RCnD, BARC, Mumbai-85.

क्रमांक:- 3293 दिनांक:- 27.12.2013

विषय:- **Construction of Institutional Campus and Residential Township for Global Centre for Nuclear Energy Partnership (GCNEP) at Kheri-Jassor and Jassor-Kheri village, Bahadurgarh in the State of Haryana.**

संदर्भ:- आपका पत्रांक GCNEP/81 दिनांक 26.12.2013

--00--

उपरोक्त विषय के सम्बन्ध में आप द्वारा प्रस्तुत किये गये खसरा न0 व किला न0 में किसी प्रकार की वन भूमि शामिल नहीं है। इसलिये आप द्वारा प्रस्तुत किये गये खसरा न0 व किला न0 में Institutional Campus and Residential Township for Global Centre for Nuclear Energy Partnership (GCNEP) का निर्माण करने पर इस कार्यालय को कोई आपत्ति नहीं है।

संलग्न - उपरोक्त खसरा सूची

Satish Singh
वन मण्डल अधिकारी,
झज्जर।

Deep Prakash
डॉ. दीप प्रकाश / Dr. Deep Prakash
परियोजना निदेशक / Project Director
वैश्विक नाभिकीय ऊर्जा साझेदारी केन्द्र (जी.सी.एन.ई.पी.)
Global Centre for Nuclear Energy Partnership (G.C.N.E.P.)
प.ऊ.वि., भारत सरकार / D.A.E., Government of India
बहादुरगढ़ (हरियाणा) / Bahadurgarh (Haryana) -124507

FAX NO.

13 May 2010 4:41PM P1

HARYANA GOVERNMENT DEVELOPMENT AND PANCHAYATS DEPARTMENT ORDER

No.

Whereas the Gram Panchayat Kheri Jasaur passed a resolution No. 1 dated 3.4.2010 for sale of its land measuring 123 Acre 2 Kanal 17 Marla falling in khasra Nos. 32/1(7-11), 32/2(8-0), 8(8-0), 7(8-0), 9(8-0), 10(8-0), 11(8-0), 12(8-0), 13(8-0), 14(8-0), 15(8-0), 16(8-0), 17(8-0), 18(8-0), 19(8-0), 20(8-0), 21(8-0), 22(8-0), 23(8-0), 24(8-0), 25(8-0), 33/1(8-0), 2(8-0), 3(8-0), 5(5-15), 6(5-10), 7(5-12), 8(8-0), 9(8-0), 10(8-0), 11(7-12), 12(8-0), 13(8-0), 14(5-14), 15(5-3), 16(4-16), 17(8-12), 18(8-0), 19(8-0), 20(7-12), 21(7-12), 22(8-0), 23(8-0), 24(7-11), 25(3-18), 34/5/2(2-5), 6(8-0), 15(8-0), 92/5(7-2), 6(8-0), 15(8-0), 16(8-0), 17(8-0), 18(8-0), 93/3(7-11), 4(7-11), 5/1(1-3), 1(7-3), 2(7-11), 5/2(3-4), 6/1(2-12), 11(7-12), 12(8-0), 13(8-0), 14(8-0), 15/1(2-8), 15/2(2-0), 16/1(1-14), 16/2(2-14), 17(8-0), 18(8-0), 6/2(1-16), 7(8-0), 8(8-0), 9(8-0), 10(7-12), 19(8-0), 20(7-12), 23(8-0), 24(8-0), 25/1(3-4), 25/2(1-4), 94/1(8-0), 2(8-0), 3(8-0), 4(8-0), 5(8-0), 6(8-0), 7(8-0), 8(8-0), 9(8-0), 10(8-0), 11(8-0), 12(8-0), 13(8-0), 14(8-0), 15(8-0), 17(8-0), 18(8-0), 19(8-0), 20(8-0), 62/16(7-4), 25(8-0), 33/21(9-18), 22(4-16), 115/1(8-0), 2(8-0), 3(8-0), 8(8-0), 9(8-0), 10(7-6), 11(7-2), 12(8-0), 13(8-0), 17/3(2-2), 18(8-0), 19(8-0), 20(8-4), 21/2(4-12), 22(8-0), 23/1(8-13), 116/5/2(0-16), 125/1/2(2-0), 2(7-12), 3/1(3-11), 9(0-3), 10/1(0-4), 94/21(8-0), 22(8-0), 23(8-0), 24(8-0), 31/1(8-0), 2(8-0), 3(8-0), 8(8-0), 9(8-0), 10(8-0), 11(8-0), 12(8-0) & 13(8-0) and the Gram Panchayat Jasaur Kheri, Block Bahadurgarh, District Jhajjar passed a resolution No. 1 dated 8.3.2010 for sale of its land measuring 83 Acre 4 Kanal 16 Marla falling in Khasra No. 32/12(8-0), 32/13(8-0), 32/5(8-0), 32/9(8-0), 65/20(8-0), 33/6(8-0), 33/7(8-0), 33/5(8-0), 34/8(8-0), 34/9(8-0), 35/11(8-0), 35/12(8-0), 32/1(8-0), 32/20(8-0), 32/21(8-0), 32/19(8-0), 32/22(8-0), 32/10(8-0), 32/11(8-0), 30/22/2(4-8), 30/23(8-0), 30/24(8-0), 30/25/1(5-14), 50/19(8-0), 50/20(8-0), 34/1/2(4-0), 34/2(8-0), 34/3(8-0), 34/6(8-0), 34/7(8-0), 100/3(8-0), 100/4(8-0), 100/7(1-18), 100/8(1-13), 65/1(8-0), 51/2(8-0), 51/3(8-0), 51/4(10-8), 65/2(8-0), 34/4(8-0), 34/5(8-0), 51/16(8-0), 51/17(8-8), 51/24(9-12), 51/25(8-0), 50/21(8-0), 50/22(8-0), 50/23(8-0), 50/8(8-0), 50/11(8-0), 50/12(8-0), 50/13(8-0), 34/16(8-0), 34/17(8-0), 34/18(8-0), 34/19/1(4-0), 34/22/2(3-18), 34/23(8-0), 34/24(8-0), 34/25(8-0), 35/21(8-0), 51/15(11-2), 50/24(8-0), 50/25(7-12), 34/12(8-0), 34/13(8-0), 34/14(8-0), 34/15(8-0), 35/9(8-0), 35/10(8-0), 32/18(8-0), 32/23(8-0), 100/1(8-0), 100/2(8-0), 100/3(1-2), 100/10(0-18), 100/5(8-0), 100/6(1-7), 32/24(8-0), 32/25(8-0), 32/14(8-0), 32/7(8-0), 32/15(8-0), 50/16(8-0), 50/18(8-0), 51/7(6-14), 51/8(8-0), 51/9(8-0), 51/12/1(2-0), 51/13/1(7-2) & 51/14/1(3-2) (total area of both the Gram Panchayats is 206 Acre 7 Kanal 13 Marla) to the Department of Atomic Energy, Government of India for the purpose of establishing Centre of Excellence for Global Deployment of Nuclear Energy at Market rate.

From

Director,
Fire Service, Haryana,
Panchkula.

To

✓ M/s Global Centre for Nuclear Energy Partnership,
Department of Atomic-Energy, Anushakti Bhawan,
CSM Marg, Mumbai-01.

Memo No. DFS/SF/2018/962/ 113526

Dated: 19/12/18

Subject: - Approval of Part fire fighting scheme from the fire safety point of view of the Residential Building of Phase-II Institutional Campus and Residential Township-Type-IIIC Housing Building for Global Centre for Nuclear Energy Partnership (GCNEP) at Kheri Jasaur and Jasaur Kheri Village in the State of Haryana.

With reference to your letter No. FSB/175, dated 19.09.2018 on the subject cited above. In this connection, this is to inform you that the proposed building plans have been scrutinized from fire safety point of view and observed that the above said low-rise Residential building blocks are having maximum height 9.10 mtrs and consisting of G+02 upper floors. Low - Rise Residential blocks, do not fall under the purview of Haryana Fire Service Act 2009, Section 15 (1)/NBC-IV,1.2, for which clearance from the department is required.

Live
Deputy Director (Technical)-I,
for Director, Haryana Fire Service,
Panchkula.

Endst. No- DFS/SF/2018/962/

Dated

A copy is forwarded to the Fire Station Officer, Bahadurgarh (Jhajjar) with reference to his Memo No. FSB/175, dated 19.09.2018 for information and necessary action.

Sam
Deputy Director (Technical)-I,
for Director, Haryana Fire Service,
Panchkula.

Prakash
डॉ. दीप प्रकाश / Dr. Deep Prakash
परियोजना निदेशक / Project Director
वैश्विक नाभिकीय ऊर्जा साझेदारी केन्द्र (जी.सी.एन.ई.पी.)
Global Centre for Nuclear Energy Partnership (G.C.N.E.P.)
प.ऊ.वि., भारत सरकार / D.A.E., Government of India
बहादुरगढ़ (हरियाणा) / Bahadurgarh (Haryana) -124507

From

Director,
Fire Service, Haryana,
Panchkula.

To

✓ M/s Global Centre for Nuclear Energy Partnership,
Department of Atomic-Energy, Anushakti Bhawan,
CSM Marg, Mumbai-01.

Memo No. DFS/SF/2018/963/ 113528
Dated: 19/12/18

Subject: - Approval of Part fire fighting scheme from the fire safety point of view of the Residential Building of Phase-II Institutional Campus and Residential Township-Type-IVD Housing Building for Global Centre for Nuclear Energy Partnership (GCNEP) at Kheri Jasaur and Jasaur Kheri Village in the State of Haryana.

With reference to your letter No. FSB/173, dated 19.09.2018 on the subject cited above. In this connection, this is to inform you that the proposed building plans have been scrutinized from fire safety point of view and observed that the above said low-rise Residential building blocks are having maximum height 9.10 mtrs and consisting of G+02 upper floors. Low - Rise Residential blocks, do not fall under the purview of Haryana Fire Service Act 2009, Section 15 (1)/NBC-IV,1.2, for which clearance from the department is required.



Deputy Director (Technical)-I,
for Director, Haryana Fire Service,
Panchkula. 

Endst. No- DFS/SF/2018/963/

Dated

A copy is forwarded to the Fire Station Officer, Bahadurgarh (Jhajjar) with reference to his Memo No. FSB/173, dated 19.09.2018 for information and necessary action.

Deputy Director (Technical)-I,
for Director, Haryana Fire Service,
Panchkula.

डॉ. दीप प्रकाश / Dr. Deep Prakash
परियोजना निदेशक / Project Director
वैश्विक नाभिकीय ऊर्जा साझेदारी केन्द्र (जी.सी.एन.ई.पी.)
Global Centre for Nuclear Energy Partnership (G.C.N.E.P.)
प.ऊ.वि., भारत सरकार / D.A.E., Government of India
बहादुरगढ़ (हरियाणा) / Bahadurgarh (Haryana) -124507

From Director General

Fire Service, Haryana Panchkula

To M/s GCNEP

Kheri Jasaur Bahadurgarh Jhajjar Haryana 124505

Memo No. FS/2018/135 dated : 28/11/2018

Subject : Approval of fire fighting scheme Under 15 mtrs. from the fire safety point of view for Group D- Assembly Building at GCNEP Kheri Jasaur Bahadurgarh Jhajjar Haryana 124505 of GCNEP :

Reference your Transaction Id 070421823000197 dated: 06/09/2018 on the subject cited above.

Your case for the approval of fire fighting scheme has been examined by the team of Fire Station Officers, Bahadurgarh Main, . The Fire fighting scheme is found as per the National Building Code of India Part IV guidelines. Therefore your proposed fire fighting scheme is hereby approved as per following detail from the fire safety point of view with the following conditions:-

Tower Name	Floor Detail	Terrace Height of Last Livable Floor(In Meters)	Ground Coverage
Block A	Ground only	8.80	2000.00
Block B	Ground only	5.00	3150.00
Tower Name	Basement Level	Basement Area	Basement Remarks
	NIL	NIL	NIL

- 1) The proposed fire fighting scheme is approved as submitted in the building plan subject to the approval of building plan by the competent authority.
- 2) The approval of fire scheme by this office doesn't absolve the firm from his responsibility from all consequences, in case of fire due to any deficiencies or anything left out in the scheme submitted by you.
- 3) Overhead & underground water tanks provided for firefighting shall be so constructed in such a way that the domestic water tank shall filled from overflow of the fire Water tanks.
- 4) As soon as the installations of fire fighting arrangements are completed, the same may be got inspected/ tested and clearance should be obtained from this office.
- 5) If the infringement of Byelaws remains un- noticed the Authority reserves the right to amend the Plans/Fire Fighting Scheme as and when any such infringement comes to notice after giving an opportunity of being heard and the Authority shall stand Indemnified against any claim on this account.
- 6) If you fail to comply with any of the above terms & conditions you will be liable to be punished as per Chapter-III Section 31 Sub-Section 1 & 2 of Fire Act 2009 i.e. imprisonment for a term which may extend to three month or fine which may extend to five thousand rupees or both.
- 7) The staircase shall be made with the specified material enabling it non-slippery.
- 8) If the gap between ceiling and false ceiling is more than 800 mm then upright sprinkler and detectors above false ceiling & pendent sprinkler below false ceiling shall be installed in the building

Remarks:- Application Updated



Deep Prakash

डॉ. दीप प्रकाश / Dr. Deep Prakash
परियोजना निदेशक / Project Director
वैश्विक नाभिकीय ऊर्जा साझेदारी केन्द्र (जी.सी.एन.ई.पी.)
Global Centre for Nuclear Energy Partnership (G.C.N.E.P.)
प.ऊ.वि., भारत सरकार / D.A.E., Government of India
बहादुरगढ़ (हरियाणा) / Bahadurgarh (Haryana) -124507

Deputy Director (Technical)-I,
for Director General, Fire
Service, Haryana
Panchkula



Digitally signed by Sumesh Kumar
Date: 2018.11.28 17:28:29 +05:30
Reason: Digital Verification

Ref: GCNEP / Elec/01

Date: 26th December 2013

To
Project Director, GCNEP
Reactor Control Division,
Bhabha Atomic Research Centre
Mumbai.

Sub: **Construction of Institutional Campus and Residential Township for Global Centre for Nuclear Energy Partnership (GCNEP) at KheriJasaur and JasaurKheri village in the State of Haryana**
- Electric Supply for GCNEP Campus & Township

Ref: 1. Your letter dated 26.12.13 and Check list received from State Environment Impact Assessment Authority (SEIAA).

Dear Sir,

This is to assure you that the necessary Electricity supply shall be provided for, both the sites at KheriJasaur and Jasaur Kheri villages, for setting up GCNEP project. *as per Affair Instruction*

Dr. Deep Prakash
डॉ. दीप प्रकाश / Dr. Deep Prakash
परियोजना निदेशक / Project Director
वैश्विक नाभिकीय ऊर्जा साझेदारी केंद्र (जी.सी.एन.ई.पी.)
Global Centre for Nuclear Energy Partnership (G.C.N.E.P.)
प.ऊ.वि., भारत सरकार / D.A.E., Government of India
बहादुरगढ़ (हरियाणा) / Bahadurgarh (Haryana) -124507

R
SDO HBVN,
Bahadurgarh, Haryana.
SDO S/O S/DIVN.
HBVN Bahadurgarh

From

Director General,
Fire Service, Haryana,
Panchkula.

To

M/s Global Center for Nuclear Energy Partnership,
Village-Jasaur Kheri, Teh-Bahadurgarh,
Distt. Jhajjar.

Memo No. DFS/Supdt/2017/751/
Dated: 7/4/17

82539

Subject: Approval of fire fighting scheme from the fire safety point of view of the Assembly Building (Central Building) at village-Jasaur Kheri, The-Bahadurgarh, Distt. Jhajjar of M/s Global Center for Nuclear Energy Partnership.

Reference on the subject cited above.

Your case for the approval of fire fighting scheme has been examined as recommended by the Fire Station Officer, Bahadurgarh, Jhajjar. The Fire fighting scheme is found as per the N.B.C. 1983 Part IV revised 2005/ guidelines. Therefore, your proposed fire fighting scheme is hereby approved from the fire safety point of view with the following conditions:-

- 1) The proposed fire fighting scheme is approved as submitted in the building plan subject to the approval of building plan by the competent authority.
- 2) The approval of fire scheme by this office doesn't absolve the firm from his responsibility from all consequences, in case of fire due to any deficiencies or anything left out in the scheme submitted by you.
- 3) Overhead & underground water tanks provided for firefighting shall be so constructed in such a way that the domestic water tank shall filled from overflow of the fire Water tanks.
- 4) As soon as the installations of fire fighting arrangements are completed, the same may be got inspected/ tested and clearance should be obtained from this office.
- 5) If the infringement of Byelaws remains un-noticed the Authority reserves the right to amend the Plans/Fire Fighting Scheme as and when any such infringement comes to notice after giving an opportunity of being heard and the Authority shall stand Indemnified against any claim on this account.
- 6) If you fail to comply with any of the above terms & conditions you will be liable to be punished as per Chapter-III Section 31 Sub-Section 1 & 2 of Fire Act 2009 i.e. imprisonment for a term which may extend to three month or fine which may extend to five thousand rupees or both.
- 7) The staircase shall be made with the specified material enabling it non-slippery.
- 8) If the gap between ceiling and false ceiling is more than 800 mm then upright sprinkler and detectors above false ceiling & pendent sprinkler below false ceiling shall be installed in the building.

Deputy Director (Technical)-I,
for Director General, Haryana Fire Service,
Panchkula.

Endst. No- DFS/Supdt/2017/751/

Dated:

A copy is forwarded to the Fire Station Officer, Bahadurgarh, Jhajjar with reference to his Memo No. 390/FSB, dated 12.09.2016 for information and necessary action.

Deputy Director (Technical)-I,
for Director General, Haryana Fire Service,
Panchkula.

Dr. Deep Prakash
डॉ. दीप प्रकाश / Dr. Deep Prakash
परियोजना निदेशक / Project Director
वैश्विक नाभिकीय ऊर्जा साझेदारी केन्द्र (जी.सी.एन.ई.पी.)
Global Centre for Nuclear Energy Partnership (G.C.N.E.P.)
प.ऊ.वि., भारत सरकार / D.A.E., Government of India
बाहादुरगढ़ (हरियाणा) / Bahadurgarh (Haryana) -124507

ANNEXURE XV



Site Barricade with High wall

Dr. Deep Prakash

डॉ. दीप प्रकाश / Dr. Deep Prakash
परियोजना निदेशक / Project Director
वैश्विक नाभिकीय ऊर्जा साझेदारी केंद्र (जी.सी.एन.ई.पी.)
Global Centre for Nuclear Energy Partnership (G.C.N.E.P.)
प.ऊ.वि., भारत सरकार / D.A.E., Government of India
बहादुरगढ़ (हरियाणा) / Bahadurgarh (Haryana) -124507



Government of India
भारत सरकार

Phone: +912225595204

परमाणु ऊर्जा विभाग

Department of Atomic Energy

वैश्विक नाभिकीय ऊर्जा साझेदारी केन्द्र

GLOBAL CENTRE FOR NUCLEAR ENERGY PARTNERSHIP

Annexure XIV



Y. S. Mayya, OS

Project Director, GCNEP

Date: 26th December 2013

Ref: GCNEP / 83

To
The Chairman, SEIAA
ParytanBhawan
1st Floor, Sector-2, Panchkula
Tel: 0712 2565232

Sub: *Construction of Institutional Campus and Residential Township for Global Centre for Nuclear Energy Partnership (GCNEP) at KheriJasaur and JasaurKheri village in the State of Haryana.*

- Submission of Form-1, Form-1A, Environmental Management Plan and Conceptual Plan for Environmental Clearance

Ref: 1. Department's proposal submitted on 30 October 2013.
2. Check list received from State Environment Impact Assessment Authority (SEIAA) dated 06.11.2013 received on 09.12.13.

Dear Sir,

Department of Atomic Energy, Government of India decided to set up institutional campus and residential township for Global Centre for Nuclear Energy Partnership (GCNEP) project at KheriJasaur and JasaurKheri village near Bahadurgarh, in the State of Haryana.
The details of the project were submitted to your office with reference to point no.1.

Further as per the prerequisite in check list above referred at point no.2, We Undertake the following:-

- That no construction has been started at the site along with latest attested photograph.
- That we will not encroach the revenue rasta passing through the project area shown in the zoning plan and layout plan.
- That we will keep the ROW required for HT wire passing through the project area as per Government instruction.
- That we will not use ground water for construction and will use treated water confirmation the ISI standards for building construction.
- That we will use ultra low sulphur diesel.
- That provision for Helipad shall be made in case of the building having height more than 61 meter. Provision of atleast one Hydraulic ladder for high rise building shall also be made.
- The infrastructure will not obstruct or divert the natural flow of water covered or open nallah, drainage of rain water as per natural flow of water.

Thanking you

Yours faithfully

Y. S. Mayya

Project Director, GCNEP

Reactor Control Division, Bhabha Atomic Research Centre

Tel: 022 2559 5204

E-mail: ysmayya@barc.gov.in

Y. S. MAYYA
Project Director, GCNEP
DAE, Govt. of India

RCnD, BARC, Mumbai-85

वाई.एस. मय्या / Y.S. Mayya

परियोजना निदेशक / Project Director
वैश्विक नाभिकीय ऊर्जा साझेदारी केन्द्र (जी.सी.एन.पी.)
Global Centre for Nuclear Energy Partnership (GCNEP)
प.ऊ.वि., भारत सरकार / D.A.E., Government of India
बहादुरगढ़ (हरियाणा) / Bahadurgarh (Haryana)

Dr. Deep Prakash
डॉ. दीप प्रकाश / Dr. Deep Prakash
परियोजना निदेशक / Project Director
वैश्विक नाभिकीय ऊर्जा साझेदारी केन्द्र (जी.सी.एन.पी.)
Global Centre for Nuclear Energy Partnership (GCNEP)
प.ऊ.वि., भारत सरकार / D.A.E., Government of India
बहादुरगढ़ (हरियाणा) / Bahadurgarh (Haryana)



Water Sprinkling at Site.

Dr. Deep Prakash

डॉ. दीप प्रकाश / Dr. Deep Prakash
परियोजना निदेशक / Project Director
वैश्विक नाभिकीय ऊर्जा साझेदारी केन्द्र (जी.सी.एन.ई.पी.)
Global Centre for Nuclear Energy Partnership (G.C.N.E.P.)
प.ऊ.वि., भारत सरकार / D.A.E., Government of India
बहादुरगढ़ (हरियाणा) / Bahadurgarh (Haryana) -124507

Annexure-XVII

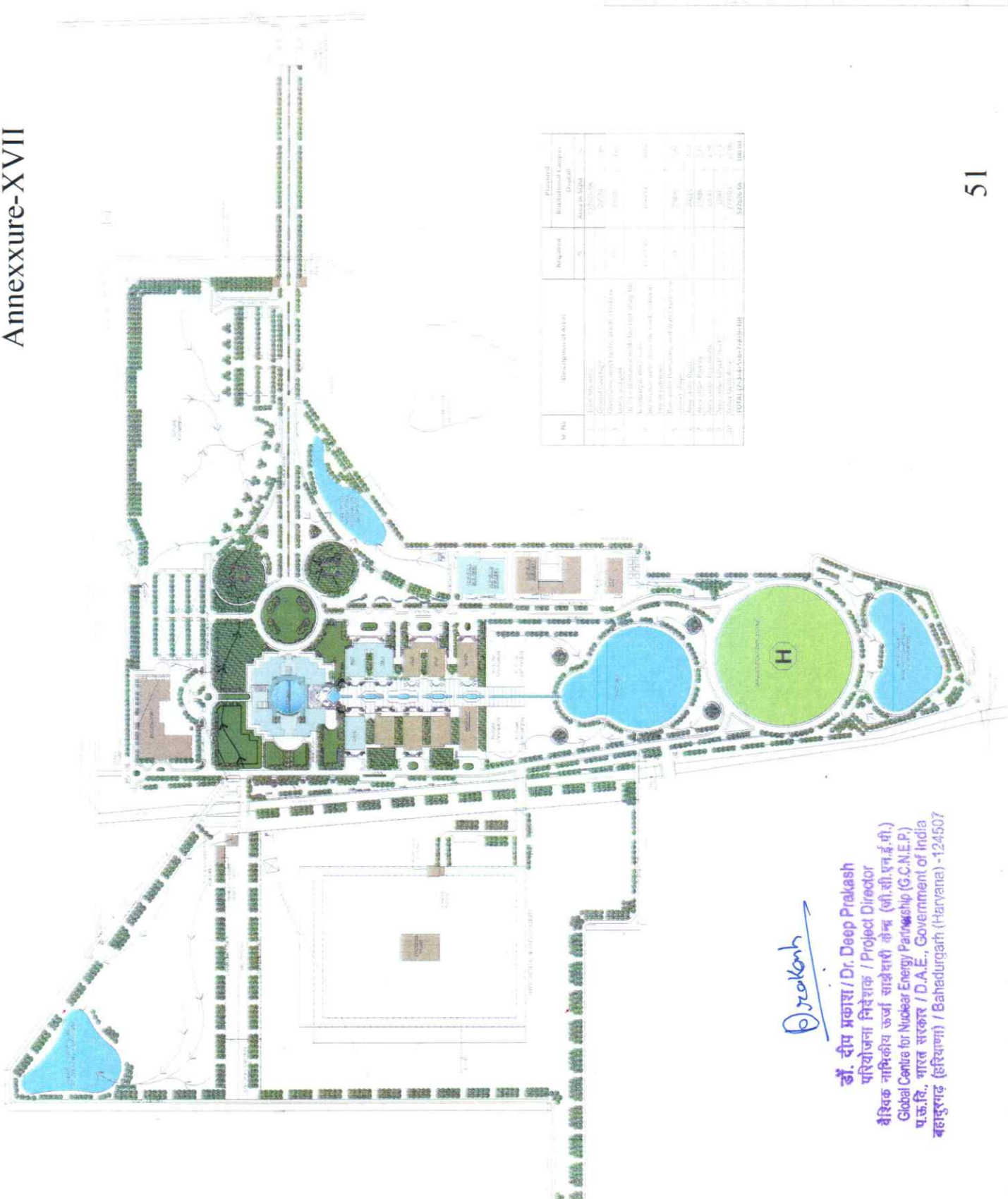

Sr. No.	Description of Area	Required	Planned
1.	Proposed Road	10000 Sq. M.	10000 Sq. M.
2.	Proposed Drainage	10000 Sq. M.	10000 Sq. M.
3.	Proposed Water Body	10000 Sq. M.	10000 Sq. M.
4.	Proposed Green Area	10000 Sq. M.	10000 Sq. M.
5.	Proposed Building	10000 Sq. M.	10000 Sq. M.
6.	Proposed Fencing	10000 Sq. M.	10000 Sq. M.
7.	Proposed Gate	10000 Sq. M.	10000 Sq. M.
8.	Proposed Wall	10000 Sq. M.	10000 Sq. M.
9.	Proposed Light	10000 Sq. M.	10000 Sq. M.
10.	Proposed Sign	10000 Sq. M.	10000 Sq. M.
11.	Proposed Tree	10000 Sq. M.	10000 Sq. M.
12.	Proposed Plant	10000 Sq. M.	10000 Sq. M.
13.	Proposed Flower	10000 Sq. M.	10000 Sq. M.
14.	Proposed Fruit	10000 Sq. M.	10000 Sq. M.
15.	Proposed Leaf	10000 Sq. M.	10000 Sq. M.
16.	Proposed Root	10000 Sq. M.	10000 Sq. M.
17.	Proposed Stem	10000 Sq. M.	10000 Sq. M.
18.	Proposed Branch	10000 Sq. M.	10000 Sq. M.
19.	Proposed Twig	10000 Sq. M.	10000 Sq. M.
20.	Proposed Bark	10000 Sq. M.	10000 Sq. M.
21.	Proposed Seed	10000 Sq. M.	10000 Sq. M.
22.	Proposed Fruit	10000 Sq. M.	10000 Sq. M.
23.	Proposed Leaf	10000 Sq. M.	10000 Sq. M.
24.	Proposed Root	10000 Sq. M.	10000 Sq. M.
25.	Proposed Stem	10000 Sq. M.	10000 Sq. M.
26.	Proposed Branch	10000 Sq. M.	10000 Sq. M.
27.	Proposed Twig	10000 Sq. M.	10000 Sq. M.
28.	Proposed Bark	10000 Sq. M.	10000 Sq. M.
29.	Proposed Seed	10000 Sq. M.	10000 Sq. M.
30.	Proposed Fruit	10000 Sq. M.	10000 Sq. M.
31.	Proposed Leaf	10000 Sq. M.	10000 Sq. M.
32.	Proposed Root	10000 Sq. M.	10000 Sq. M.
33.	Proposed Stem	10000 Sq. M.	10000 Sq. M.
34.	Proposed Branch	10000 Sq. M.	10000 Sq. M.
35.	Proposed Twig	10000 Sq. M.	10000 Sq. M.
36.	Proposed Bark	10000 Sq. M.	10000 Sq. M.
37.	Proposed Seed	10000 Sq. M.	10000 Sq. M.
38.	Proposed Fruit	10000 Sq. M.	10000 Sq. M.
39.	Proposed Leaf	10000 Sq. M.	10000 Sq. M.
40.	Proposed Root	10000 Sq. M.	10000 Sq. M.
41.	Proposed Stem	10000 Sq. M.	10000 Sq. M.
42.	Proposed Branch	10000 Sq. M.	10000 Sq. M.
43.	Proposed Twig	10000 Sq. M.	10000 Sq. M.
44.	Proposed Bark	10000 Sq. M.	10000 Sq. M.
45.	Proposed Seed	10000 Sq. M.	10000 Sq. M.
46.	Proposed Fruit	10000 Sq. M.	10000 Sq. M.
47.	Proposed Leaf	10000 Sq. M.	10000 Sq. M.
48.	Proposed Root	10000 Sq. M.	10000 Sq. M.
49.	Proposed Stem	10000 Sq. M.	10000 Sq. M.
50.	Proposed Branch	10000 Sq. M.	10000 Sq. M.
51.	Proposed Twig	10000 Sq. M.	10000 Sq. M.
52.	Proposed Bark	10000 Sq. M.	10000 Sq. M.
53.	Proposed Seed	10000 Sq. M.	10000 Sq. M.
54.	Proposed Fruit	10000 Sq. M.	10000 Sq. M.
55.	Proposed Leaf	10000 Sq. M.	10000 Sq. M.
56.	Proposed Root	10000 Sq. M.	10000 Sq. M.
57.	Proposed Stem	10000 Sq. M.	10000 Sq. M.
58.	Proposed Branch	10000 Sq. M.	10000 Sq. M.
59.	Proposed Twig	10000 Sq. M.	10000 Sq. M.
60.	Proposed Bark	10000 Sq. M.	10000 Sq. M.
61.	Proposed Seed	10000 Sq. M.	10000 Sq. M.
62.	Proposed Fruit	10000 Sq. M.	10000 Sq. M.
63.	Proposed Leaf	10000 Sq. M.	10000 Sq. M.
64.	Proposed Root	10000 Sq. M.	10000 Sq. M.
65.	Proposed Stem	10000 Sq. M.	10000 Sq. M.
66.	Proposed Branch	10000 Sq. M.	10000 Sq. M.
67.	Proposed Twig	10000 Sq. M.	10000 Sq. M.
68.	Proposed Bark	10000 Sq. M.	10000 Sq. M.
69.	Proposed Seed	10000 Sq. M.	10000 Sq. M.
70.	Proposed Fruit	10000 Sq. M.	10000 Sq. M.
71.	Proposed Leaf	10000 Sq. M.	10000 Sq. M.
72.	Proposed Root	10000 Sq. M.	10000 Sq. M.
73.	Proposed Stem	10000 Sq. M.	10000 Sq. M.
74.	Proposed Branch	10000 Sq. M.	10000 Sq. M.
75.	Proposed Twig	10000 Sq. M.	10000 Sq. M.
76.	Proposed Bark	10000 Sq. M.	10000 Sq. M.
77.	Proposed Seed	10000 Sq. M.	10000 Sq. M.
78.	Proposed Fruit	10000 Sq. M.	10000 Sq. M.
79.	Proposed Leaf	10000 Sq. M.	10000 Sq. M.
80.	Proposed Root	10000 Sq. M.	10000 Sq. M.
81.	Proposed Stem	10000 Sq. M.	10000 Sq. M.
82.	Proposed Branch	10000 Sq. M.	10000 Sq. M.
83.	Proposed Twig	10000 Sq. M.	10000 Sq. M.
84.	Proposed Bark	10000 Sq. M.	10000 Sq. M.
85.	Proposed Seed	10000 Sq. M.	10000 Sq. M.
86.	Proposed Fruit	10000 Sq. M.	10000 Sq. M.
87.	Proposed Leaf	10000 Sq. M.	10000 Sq. M.
88.	Proposed Root	10000 Sq. M.	10000 Sq. M.
89.	Proposed Stem	10000 Sq. M.	10000 Sq. M.
90.	Proposed Branch	10000 Sq. M.	10000 Sq. M.
91.	Proposed Twig	10000 Sq. M.	10000 Sq. M.
92.	Proposed Bark	10000 Sq. M.	10000 Sq. M.
93.	Proposed Seed	10000 Sq. M.	10000 Sq. M.
94.	Proposed Fruit	10000 Sq. M.	10000 Sq. M.
95.	Proposed Leaf	10000 Sq. M.	10000 Sq. M.
96.	Proposed Root	10000 Sq. M.	10000 Sq. M.
97.	Proposed Stem	10000 Sq. M.	10000 Sq. M.
98.	Proposed Branch	10000 Sq. M.	10000 Sq. M.
99.	Proposed Twig	10000 Sq. M.	10000 Sq. M.
100.	Proposed Bark	10000 Sq. M.	10000 Sq. M.

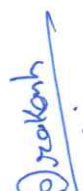
 डॉ. दीप प्रकाश / Dr. Deep Prakash
 परियोजना निदेशक / Project Director
 वैश्विक नाभिकीय ऊर्जा साझेदारी केंद्र (वी.सी.एन.ई.पी.)
 Global Centre for Nuclear Energy Partnership (G.C.N.E.P.)
 पञ्जाब, भारत सरकार / D.A.E., Government of India
 बहादुरगढ़ (हरियाणा) / Bahadurgarh (Haryana) -124507

Annexure-XVIII

LEGEND

1	ROADS
2	RAILWAYS
3	WATER
4	LAND
5	PLANTATION
6	WATER
7	WATER
8	WATER
9	WATER
10	WATER
11	WATER
12	WATER
13	WATER
14	WATER
15	WATER
16	WATER
17	WATER
18	WATER
19	WATER
20	WATER
21	WATER
22	WATER
23	WATER
24	WATER
25	WATER
26	WATER
27	WATER
28	WATER
29	WATER
30	WATER
31	WATER
32	WATER
33	WATER
34	WATER
35	WATER
36	WATER
37	WATER
38	WATER
39	WATER
40	WATER
41	WATER
42	WATER
43	WATER
44	WATER
45	WATER
46	WATER
47	WATER
48	WATER
49	WATER
50	WATER
51	WATER
52	WATER
53	WATER
54	WATER
55	WATER
56	WATER
57	WATER
58	WATER
59	WATER
60	WATER
61	WATER
62	WATER
63	WATER
64	WATER
65	WATER
66	WATER
67	WATER
68	WATER
69	WATER
70	WATER
71	WATER
72	WATER
73	WATER
74	WATER
75	WATER
76	WATER
77	WATER
78	WATER
79	WATER
80	WATER
81	WATER
82	WATER
83	WATER
84	WATER
85	WATER
86	WATER
87	WATER
88	WATER
89	WATER
90	WATER
91	WATER
92	WATER
93	WATER
94	WATER
95	WATER
96	WATER
97	WATER
98	WATER
99	WATER
100	WATER

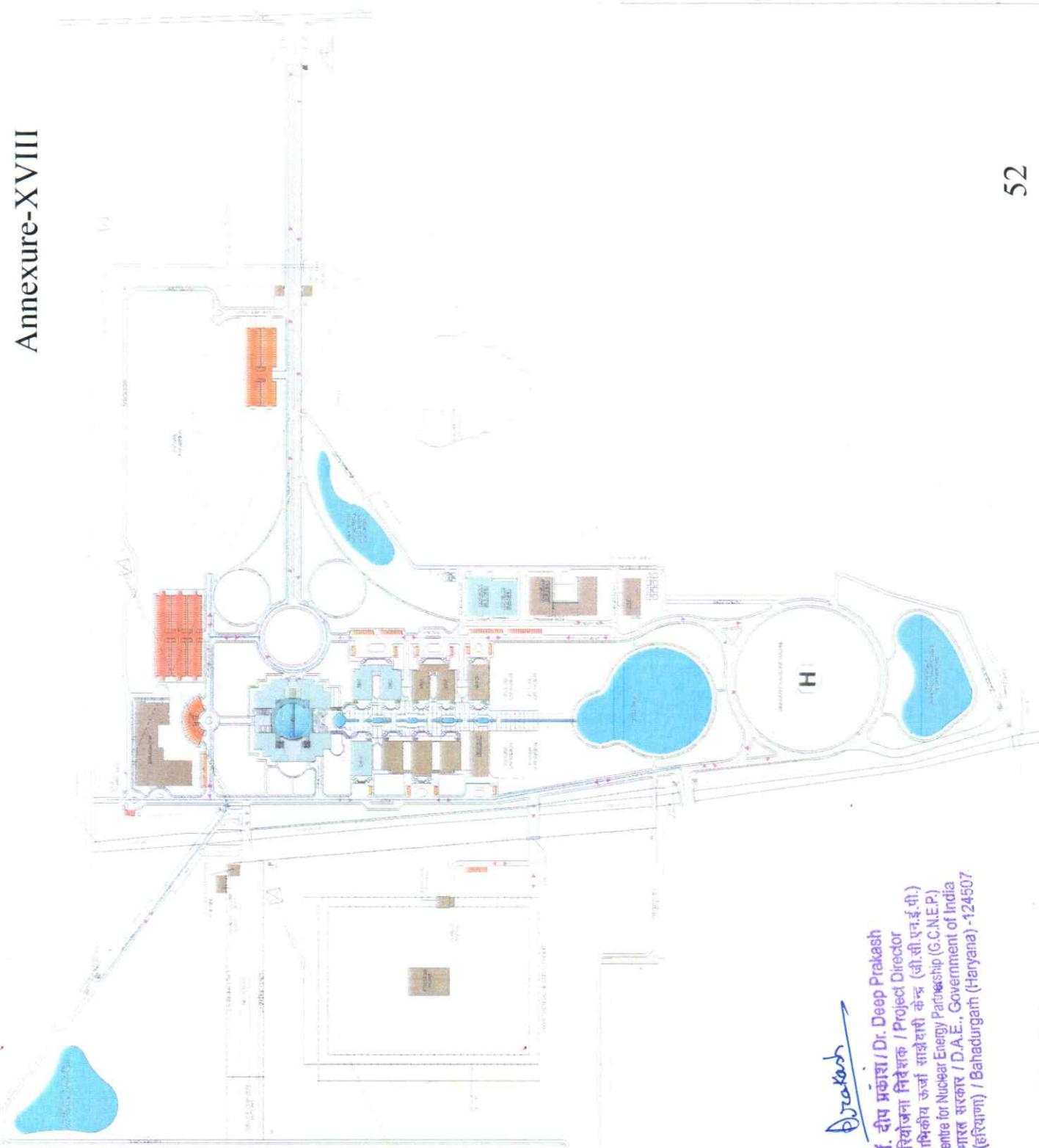

Dr. Deep Prakash
 डॉ. दीप प्रकाश / Dr. Deep Prakash
 परियोजना निदेशक / Project Director
 वैश्विक नाभिकीय ऊर्जा साझेदारी केन्द्र (जी.सी.एन.ई.पी.)
 Global Centre for Nuclear Energy Partnership (G.C.N.E.P.)
 प.ऊ.वि., भारत सरकार / D.A.E., Government of India
 बहादुरगढ़ (हरियाणा) / Bahadurgarh (Haryana) -124507



GOVERNMENT OF INDIA
DEPARTMENT OF ATOMIC ENERGY
GLOBAL CENTRE FOR NUCLEAR ENERGY PARTNERSHIP
Jasaur-Kheri, Bahadurgarh, District Jhajjar, Haryana-124505



Advt. No.: GCNEP/Advt/18/04-43 **Website: www.gcnep.gov.in**

PUBLIC NOTICE

Global Centre for Nuclear Energy Partnership (GCNEP), Government of India, Department of Atomic Energy (DAE), has obtained Environmental Clearance for expansion of Institutional campus and Residential Township project located at Village Kheri Jasaur and Jasaur Kheri, Bahadurgarh, District Jhajjar, Haryana, from Haryana State Environment Impact Assessment Authority (SEIAA), Panchkula (Haryana) vide their reference file No. SEIAA/HR/2018/231 dated: 04.04.2018.

The clearance covers construction (Existing and expansion) on a plot area of 946600.38 sqm (94.66 Hectare = 522626.68 sqm for Institutional campus+ 423973.7 sqm for Residential Township). The total built up area shall be 92979 sqm (47154 sqm institutional campus + 45825 sqm residential township). The project shall comprise of Institutional Campus and residential township having Auditorium, conference room, Canteen, E-class, Lecture room, Labs, recreation centre, dinning, Guest House & Residential housing. The project shall be constructed on a land area of 522626.68 sqm in village Kheri Jasaur and a land area of 423973.7 sqm in village Jasaur Kheri, Bahadurgarh, District Jhajjar, Haryana. In this respect, copies of Clearance letter are available with the Haryana State Pollution Control Board & Haryana State Environment Impact Assessment Authority and may also be seen at their Website at <http://www.seiaahry.in> and GCNEP Website <http://www.gcnep.gov.in>. (This is published as a statutory requirement of above cited SEIAA clearance).

-Project Director, GCNEP.

8x8 cm



भारत सरकार
परमाणु ऊर्जा विभाग
वैश्विक नाभिकीय ऊर्जा साझेदारी केंद्र
जासौर-खेड़ी, बहादुरगढ़, जिला झज्जर, हरियाणा - 124505



विज्ञापन संख्या : जी.सी.एन.ई.पी./विज्ञापन/18/04-43 **वेबसाइट: www.gcnep.gov.in**

सार्वजनिक सूचना

वैश्विक नाभिकीय ऊर्जा साझेदारी केंद्र (जी.सी.एन.ई.पी. - ग्लोबल सेंटर फॉर न्यूक्लीयर एनर्जी पार्टनरशिप), भारत सरकार, परमाणु ऊर्जा विभाग (डी.ए.ई.) को गांव जासौर खेड़ी एवं गांव खेड़ी जासौर, तहसील बहादुरगढ़, जिला झज्जर (हरियाणा) में संस्थागत एवं आवासीय परिसर के विस्तार निर्माण हेतु हरियाणा राज्य पर्यावरण प्रभाव आकलन प्राधिकरण (SEIAA पंचकुला ने, उनके संप्रषण क्रमांक. SEIAA/HR/2018/231 dated: तिथि: 04.04.2018, के द्वारा, स्वीकृति प्रदान की है।

यह स्वीकृति 946600.38 वर्ग मीटर (94.66 हेक्टर = 522626.68 वर्ग मीटर संस्थागत + 423973.7 वर्ग मीटर आवासीय) में निर्माण हेतु दी गयी है। कुल निर्मित क्षेत्र 92979 वर्ग मीटर (47154 वर्ग मीटर संस्थागत + 45825 वर्ग मीटर आवासीय) होगा। परियोजना के अंतर्गत इंस्टीट्यूशनल कैम्पस और आवासीय टाउनशिप शामिल है, जिसमें ऑडिटोरियम, सम्मेलन कक्ष, कैंटीन, इक्लास, व्याख्यान कक्ष, लैब्स, मनोरंजन केंद्र, भोजन कक्ष, गेस्ट हाउस और आवासीय आवास शामिल है। परियोजना के अंतर्गत गांव खेड़ी जासौर में 522626.68 वर्ग मीटर एवं गांव जासौर खेड़ी में 423973.7 वर्ग मीटर निर्माण होगा।

इस संदर्भ में स्वीकृति पत्र हरियाणा राज्य प्रदूषण नियंत्रण बोर्ड और हरियाणा राज्य पर्यावरण प्रभाव आकलन प्राधिकरण (SEIAA) के पास उपलब्ध है। यह जानकारी उनकी वेबसाइट at <http://www.seiaahry.in> तथा जी.सी.एन.ई.पी. की वेबसाइट <http://www.gcnep.gov.in> पर भी उपलब्ध है। यह सूचना इस स्वीकृति से जुड़ी वैधानिक आवश्यकता के तहत दी जा रही है।

-परियोजना निदेशक, जी. सी. एन. ई. पी.

Hindi 8x8 cm

Dr. Deep Prakash
डॉ. दीप प्रकाश / Dr. Deep Prakash
परियोजना निदेशक / Project Director